

### Slide Mounting Dimensions

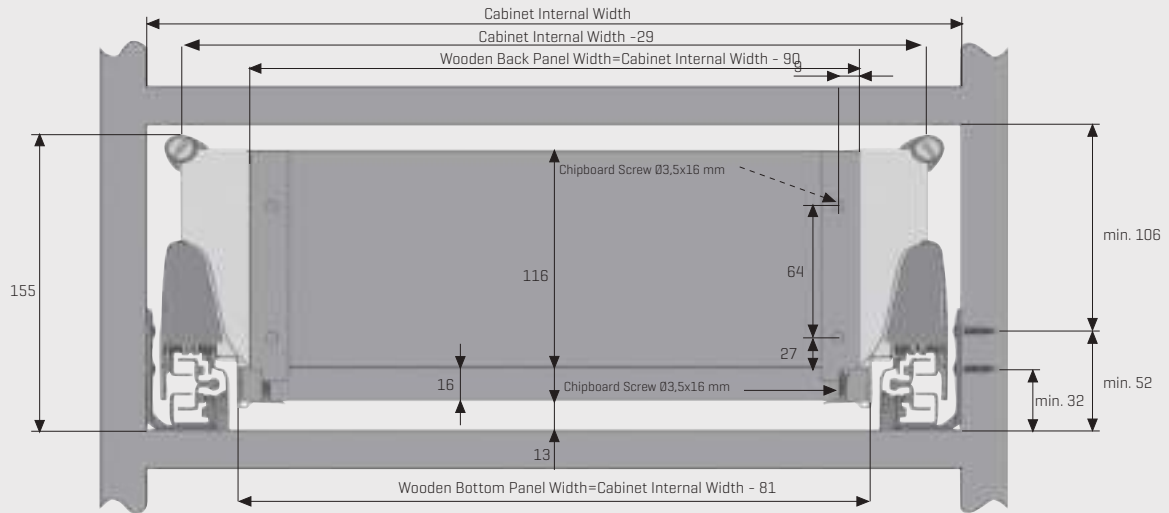

### Wooden Back Panel Application

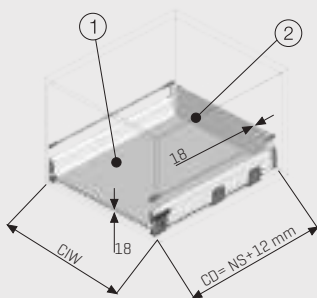

CD Cabinet Depth  
CIW Cabinet Internal Width  
NS Nominal Size

#### 1. Wooden Drawer Bottom

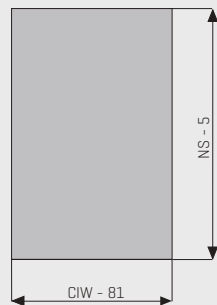

#### 2. Wooden Back Panel

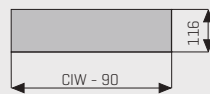

### Slide Screw Location

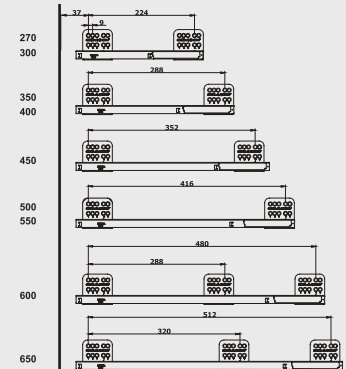

### Metal Back Panel Application

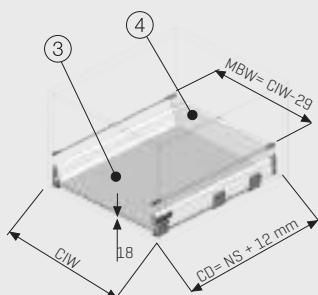

CD Cabinet Depth  
CIW Cabinet Internal Width  
NS Nominal Size  
MBW Metal Back Panel Width

#### 3. Wooden Drawer Bottom

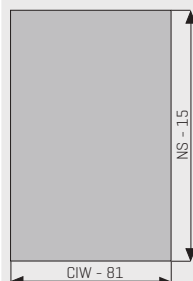

#### A Metal Back Panel Single Gallery Railing

NOMINAL SIZE	GRAY
600mm	12790343535
900mm	12790343835

Calculation Method for Front Panel Dimensions: Cut Measurement = Cabinet Internal Width - 99

### Recommended Screws For Rail Assembly

Ø3,5x16 mm Chipboard Screw



Ø6,1x11,5 mm Euro Screw



\*All dimensions in the graphs above are measured in mm

# smart box

## H 68 In-Box with Double Gallery Railing



- Improved soft closing system guarantees smooth running
- Dynamic load capacity: 40 and 65 kg
- Finish: White and Grey
- 180 mm casing height
- Wooden backboard thickness options: 18 mm
- Drawer Length for 40 kg: 350/400/450/500/550/600 mm
- Drawer Length for 65 kg: 450/500/550/600 mm
- Smart-Click: Tool free assembly and removal of front panel
- Smart-Fit: Simple and tool free assembly, as well as removal of drawer
- The improved stability guarantees a long product durability

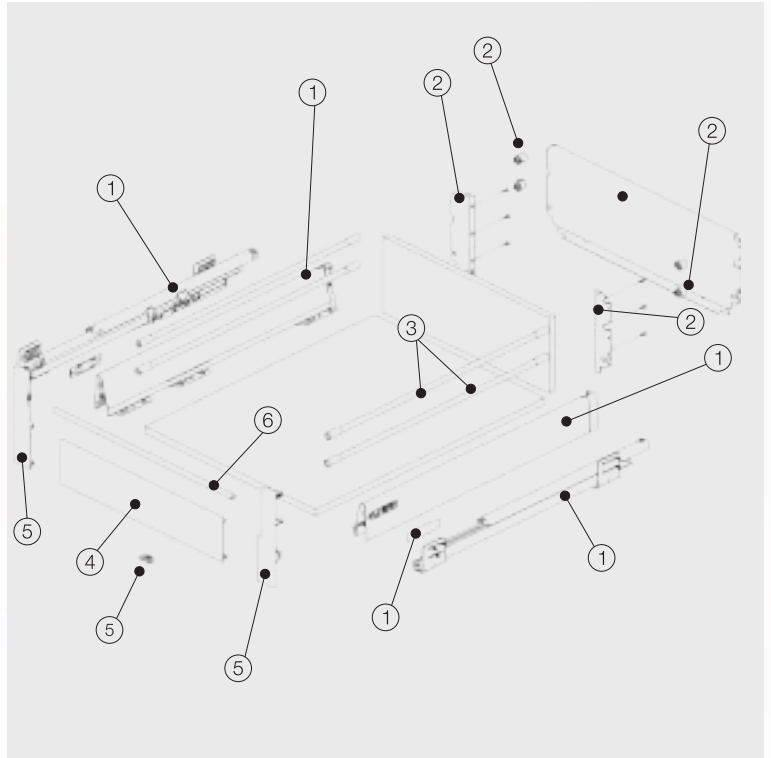

Load Capacity 40 kg	1 Smart Box Basic package	
	GREY	WHITE
NOMINAL SIZE		
350 mm	127140733	-
400 mm	127140743	-
450 mm	127140753	127140751
500 mm	127140763	127140761
550 mm	127140773	127140771
600 mm	127140783	-

Load Capacity 65 kg	1 Smart Box Basic package	
	GREY	WHITE
NOMINAL SIZE		
450 mm	127142753	127142751
500 mm	127142763	127142761
550 mm	127142773	127142771
600 mm	127142783	

2 Backboard Holder Double Gallery Railing	
Grey 18 mm	White 18 mm
12791873	12791871

3 Gallery Railing Bar		
NOMINAL SIZE	GREY	WHITE
350 mm	127901433	-
400 mm	127901443	-
450 mm	127901453	127901451
500 mm	127901463	127901461
550 mm	127901473	127901471
600 mm	127901483	-

4 Front Panel (LENGTH 1069 mm)	
COLOR	CODE
White	12791711069
Grey	12791731069

5 Front Connectors Double Gallery Railing***	
*** Front panel holder included	
Color	CODE
White	1279164411
Grey	1279164431

6 Front Gallery Railing (LENGTH 1115 mm)	
COLOR	CODE
White	12790471
Grey	12790473

### Slide Mounting Dimensions

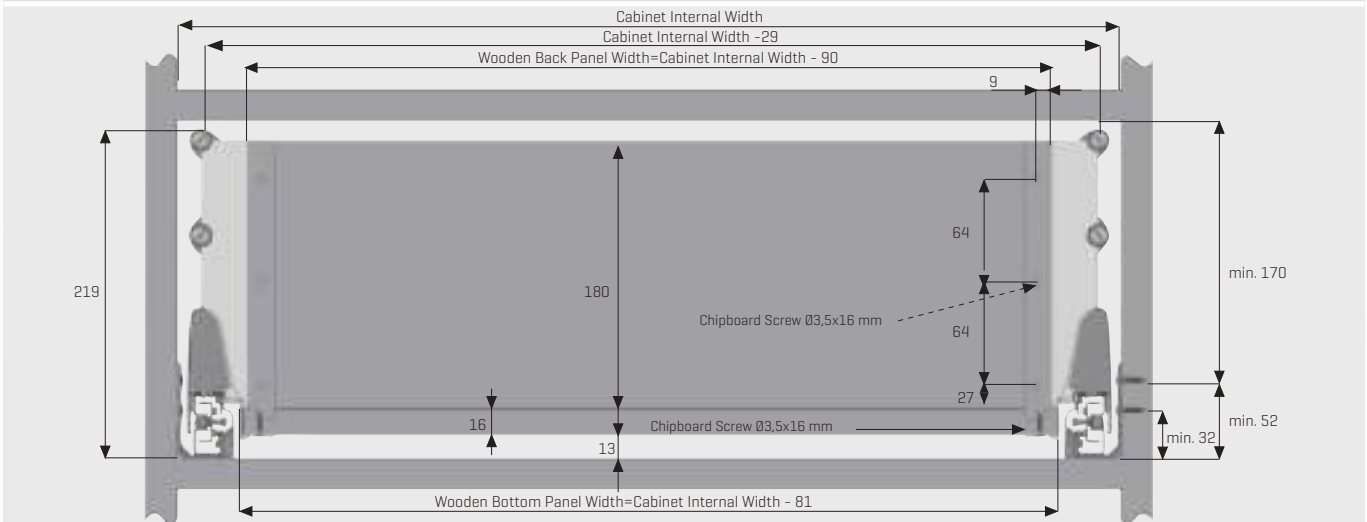

### Wooden Back Panel Application

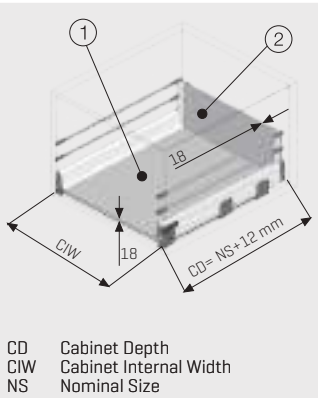

#### 1. Wooden Drawer Bottom

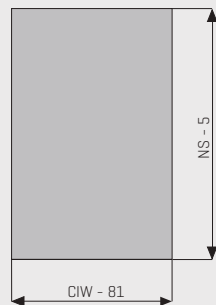

#### 2. Wooden Back Panel

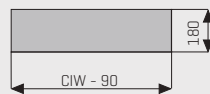

### Slide Screw Location

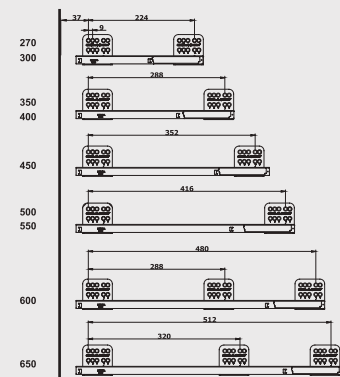

### Metal Back Panel Application

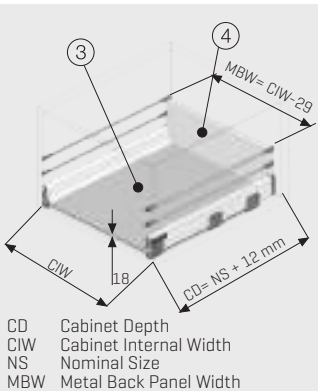

#### 3. Wooden Drawer Bottom

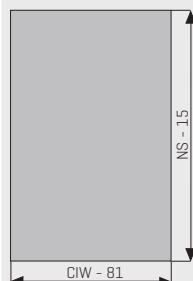

Calculation Method for Front Panel Dimensions: Cut Measurement = Cabinet Internal Width - 99  
 Calculation Method for Front Panel Dimensions: Cut Measurement = Cabinet Internal Width - 53

### Recommended Screws For Rail Assembly

Ø3,5x16 mm Chipboard Screw



Ø6,1x11,5 mm Euro Screw



\*All dimensions in the graphs above are measured in mm

# smart box

## H 68 In-Box Side Panel H:48



- Improved soft closing system guarantees smooth running
- Dynamic load capacity: 40 and 65 kg
- Finish: White and Grey
- 116 mm casing height
- Wooden backboard thickness options: 16 mm and 18 mm
- Drawer Length for 40 kg: 450/500/550/600 mm
- Drawer Length for 65 kg: 450/500/550/600 mm
- Smart-Click: Tool free assembly and removal of front panel
- Smart-Fit: Simple and tool free assembly, as well as removal of drawer
- The improved stability guarantees a long product durability

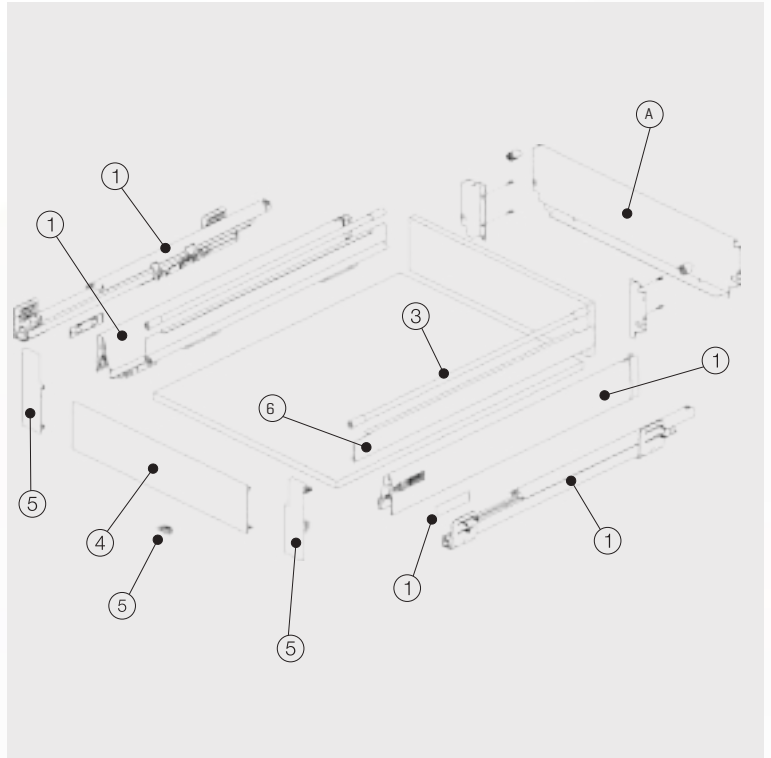

Load Capacity 40 kg	1 Smart Box Basic package	
	GREY	WHITE
NOMINAL SIZE		
450 mm	127140753	127140751
500 mm	127140763	127140761
550 mm	127140773	127140771
600 mm	127140783	-

3	Gallery Railing Bar	
	GREY	WHITE
NOMINAL SIZE		
450 mm	127901453	127901451
500 mm	127901463	127901461
550 mm	127901473	127901471
600 mm	127901483	-

Load Capacity 65 kg	1 Smart Box Basic package	
	GREY	WHITE
NOMINAL SIZE		
450 mm	127142753	127142751
500 mm	127142763	127142761
550 mm	127142773	127142771
600 mm	127142783	

4 Front Panel (LENGTH 1069 mm)	
COLOR	CODE
White	12791711069
Grey	12791731069

2 Backboard Holder Single Gallery Railing	
GREY 18 mm	White 18 mm
12791863	12791861

5 Front Connectors Single Gallery Railing*** *** Front panel holder included	
COLOR	CODE
White	1279164311
Grey	1279164331

6 Metal Side Panel	
Standard	
NOMINAL SIZE	GREY
450 mm	127900935
500 mm	127900936
550 mm	127900937
600 mm	127900938

### Slide Mounting Dimensions

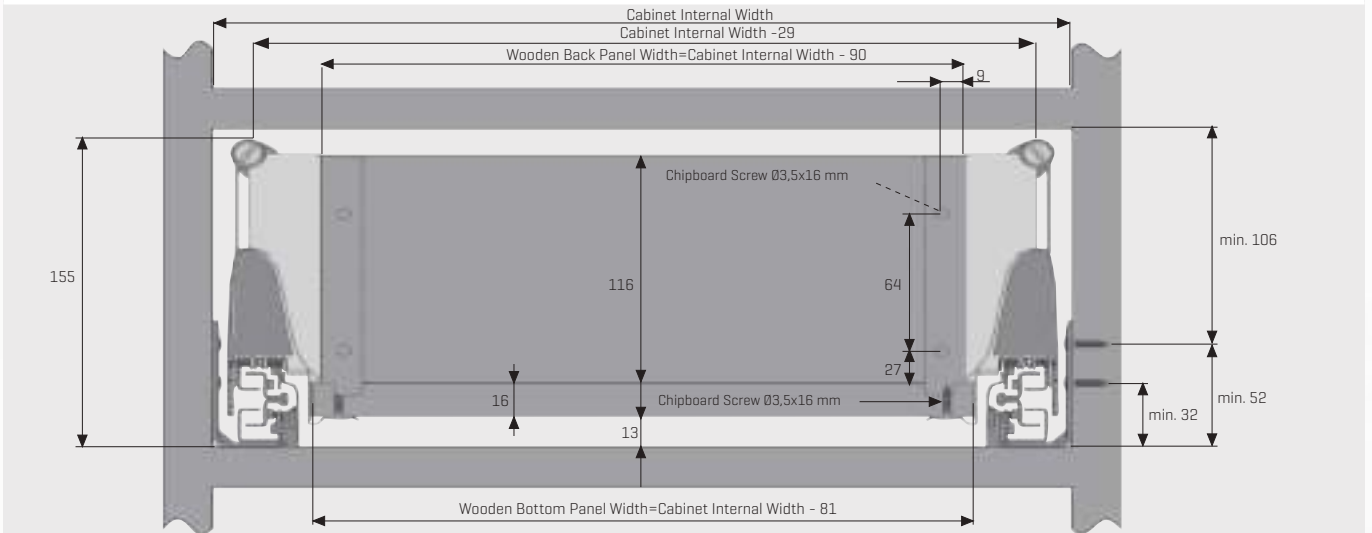

### Wooden Back Panel Application

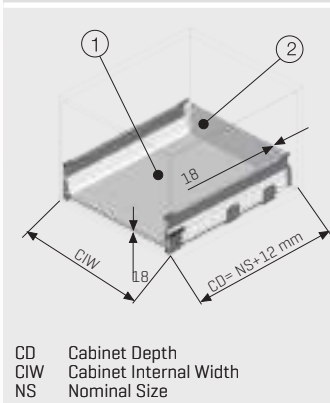

#### 1. Wooden Drawer Bottom

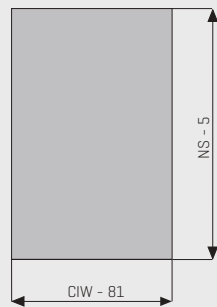

#### 2. Wooden Back Panel

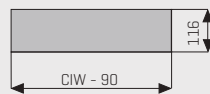

### Slide Screw Location

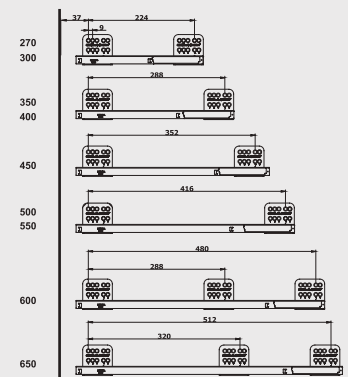

### Metal Back Panel Application

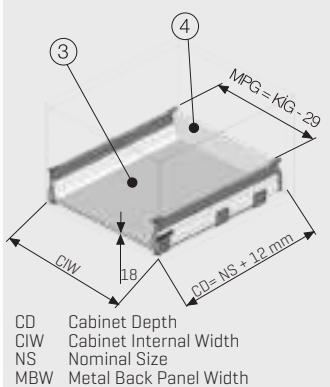

#### 3. Wooden Drawer Bottom

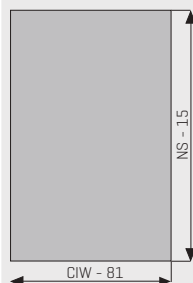

#### A Metal Back Panel Side Panel H:48

NOMINAL SIZE	Grey
600 mm	12790343535
900 mm	12790343835

Calculation Method for Front Panel Dimensions: Cut Measurement = Cabinet Internal Width - 99

### Recommended Screws For Rail Assembly

Ø3,5x16 mm Chipboard Screw



Ø6,1x11,5 mm Euro Screw



\*All dimensions in the graphs above are measured in mm

# smart box

## Sink Cabinet with Gallery Railing



- Improved soft closing system guarantees smooth running
- Set for 900 – 1.200 mm drawers.
- Various color options.
- Easy assembly.

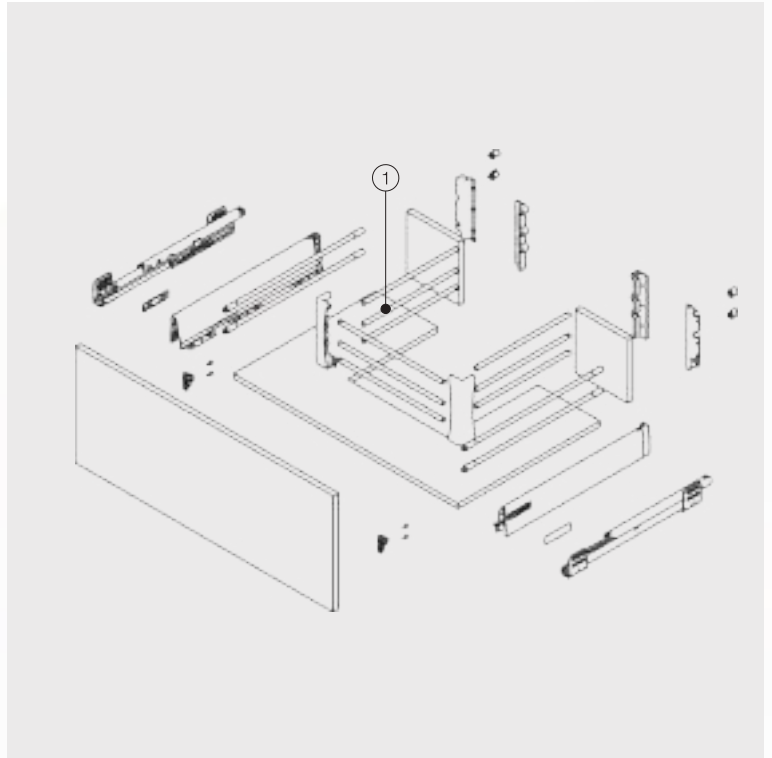

### 1 Sink Cabinet with Gallery Railing

LENGTH	CODE	COLOR
900-1200 mm	12714601	White
900-1200 mm	12714603	Grey

\*\*For 500 mm sink cabinets with wire, please  
Note: NS = 500 mm [Side length]

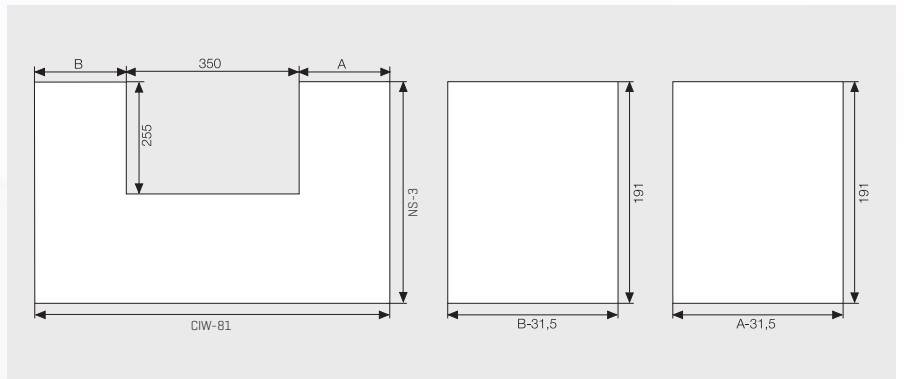

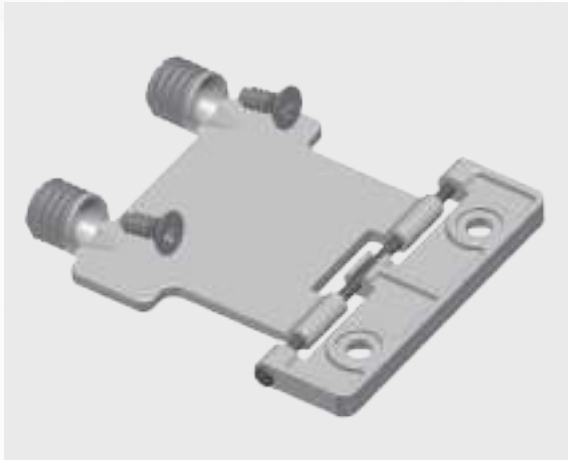

· It is used to make a more stable connection between wooden bottom panel and wooden front panel.  
 · Recommended for the application with cabinets of 600 mm width or more.

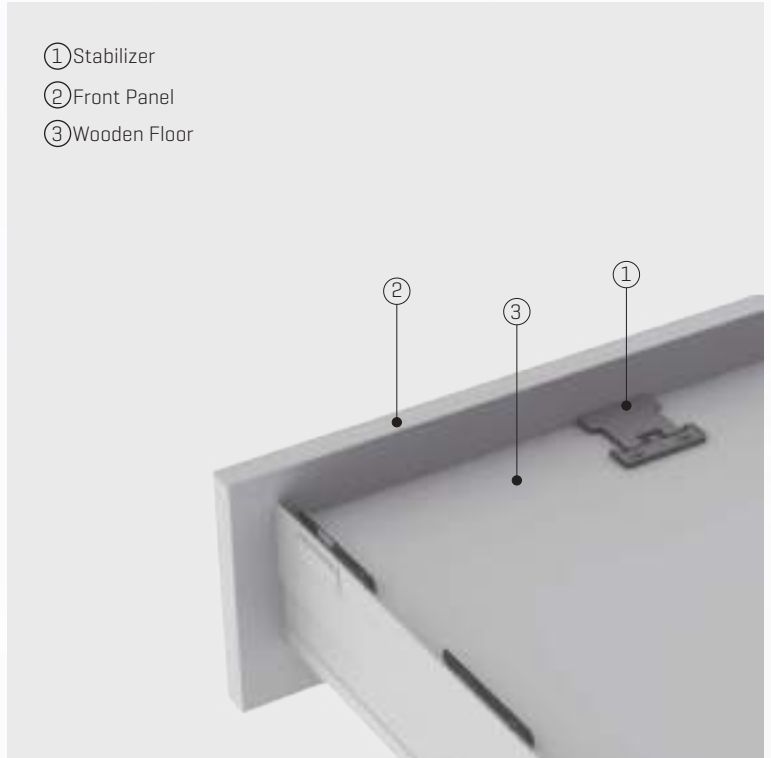

Drawer Front Stabilizer

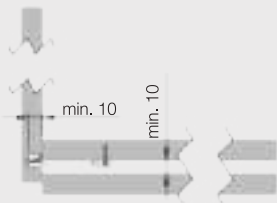

1 Drawer Front Stabilizer

CODE	COLOR
12790461	Grey

Wooden Floor Hole Dimensions



### Drawer Assembly and Mounting

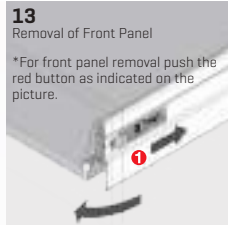
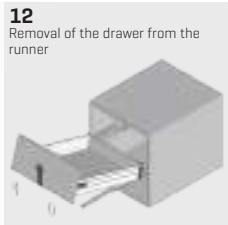
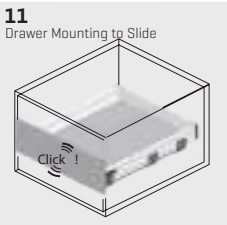
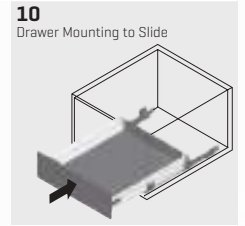
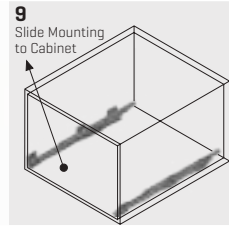
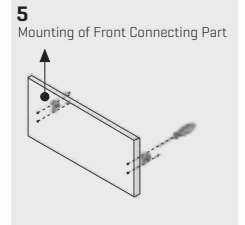
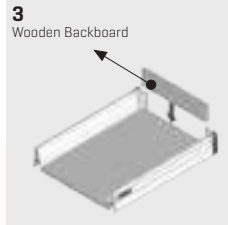
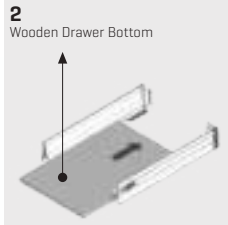
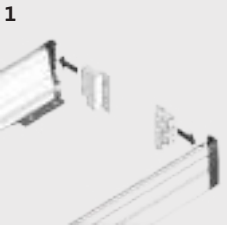



**Adjustment**



**Mounting of Wooden drawer Floor without using screws**

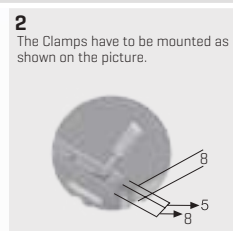

**Adjustment Mechanism**

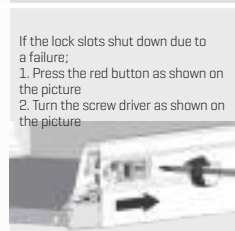

**Mounting Gallery Railing**

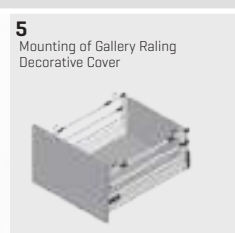
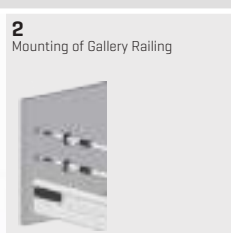
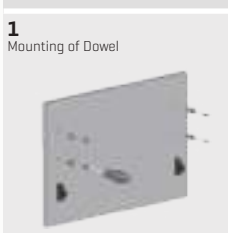

**Easy Mounting Gallery Railing Group**

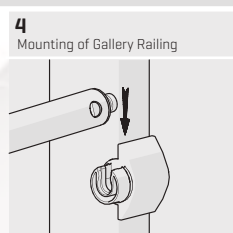
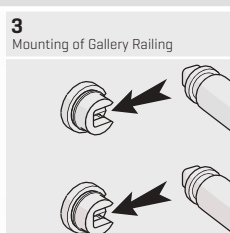
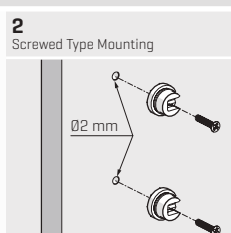
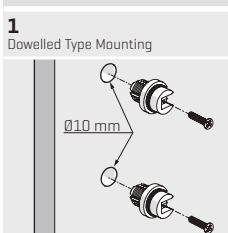

### Drawer Assembly and Mounting

<p><b>1</b></p>	<p><b>2</b> Wooden Drawer Bottom</p>	<p><b>3</b> Wooden Backboard</p>	<p><b>4</b> Wooden Backboard Mounting</p>	<p><b>5</b> Mounting of front connectors</p>
<p><b>6</b> Mounting of front connector group</p>	<p><b>7</b> Wooden Drawer Floor Mounting</p>	<p><b>8</b> Mounting of front panel stabilizer</p>	<p><b>9</b> Mounting of Gallery Railing Holders</p>	<p><b>10</b> Mounting of Gallery Railing</p>
<p><b>11</b> Mounting of Gallery Railing Decorative Cover</p>	<p><b>12</b> Decorative Cover Mounting</p>	<p><b>13</b> Cabinet</p>	<p><b>14</b> Mounting of the Drawer to the Cabinet</p>	<p><b>15</b></p>

### Removal of Drawer

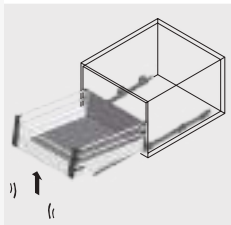

### H:112 In-Box Side Panel

<p><b>1</b></p> <p>Crush the pieces as shown.</p>	<p><b>2</b> Side Panel Mounting</p>	<p><b>3</b> Side Panel Mounting</p>
---	---	---