

Product Info

HÄFELE

www.hafeleindia.com



LEGRABOX

- Experience Elegance

 **blum**



INTRODUCTION

Straight lines create a sleek and elegant design that clearly defines LEGRABOX, Blum's new attractive full extension box system exclusively distributed by Häfele.

LEGRABOX offers an impressively slim drawer profile thickness of only 12.8 mm which is straight on the inside and the outside to maximize the usable interior space of the drawer. It is available in four luxurious finishes: Anti-fingerprint Stainless Steel, Terra Black, Orion Grey Matt and Silk White Matt, all of which give it a distinct look and feel.

The **LEGRABOX pure** programme consists of three drawer side heights for standard drawers and two drawer side heights for inner pull-outs. The versatile programme allows for a wide range of design options for any kitchen, bath or furniture application whether used with standard drawers, high fronted drawers or inner drawers. It combines design and function for well-balanced solutions creating elegance in motion.

The look of **LEGRABOX free** is characterised by large design elements that offer the freedom to individualise the design of pull-outs. No matter whether glass, wood or other materials – the design elements go beautifully with the drawer side, add a touch of luxury to furniture interiors and provide full visibility from all three sides.

The new LEGRABOX free design option can be easily combined with LEGRABOX pure, which is extremely practical in kitchens. Both options blend harmoniously into every living area, creating a consistent look for furniture in kitchens, bedrooms, living rooms and bathrooms.



CONTENT:

▪ LEGRABOX Programme	4
▪ Features & Benefits	5 - 7
▪ Technology	8
▪ Product Range Overview	9 - 11
▪ BOM Components	12 - 22
▪ TANDEMBOX V/S LEGRABOX	23 - 24
▪ Important Information	25
▪ BOM Article No. Table	26 - 29
▪ Ordering Information	30 - 39

LEGRABOX PROGRAMME



◀◀ *LEGRABOX pure*

LEGRABOX free ▶▶

Orion Grey Matt

Silk White Matt

Anti-fingerprint
Stainless Steel

Terra Black Matt

FEATURES

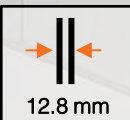

Slim Design: Inspiration for the new LEGRABOX design has been derived from the current trend of minimalistic interiors. The impressively slim **12.8 mm** side panels, which are straight on the inside and outside, can be inserted harmoniously into any furniture.

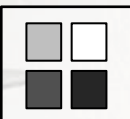

New Colour Concept: LEGRABOX features a completely new colour concept. The entire material is made either from anti-fingerprint stainless steel or steel with matt coating, giving it a unique feel



Advanced Runner Technology: LEGRABOX leads the way in terms of technology. Its innovative runner system offers greater ease of use. The synchronisation of the drawer profile, roller carriage and the cabinet profile enables easy transition with smooth running action and low opening forces

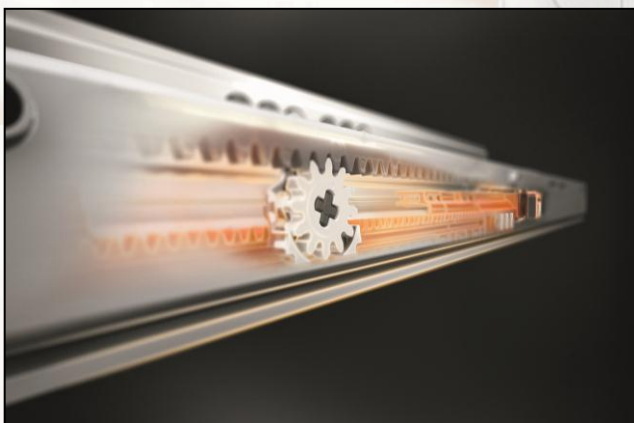

FEATURES



40 Kg.
70 Kg.

Weight Carrying Capacity: LEGRABOX performs outstandingly even when fully extended and heavily loaded. Even very wide and heavy pull-outs have low sag values and a smooth running action thanks to the dynamic weight carrying capacity of 40 and 70 kg.



Stability: High fronts are becoming more and more significant as a design element. LEGRABOX supports this design trend with a new type of front fixing bracket that guarantees maximum stability while opening and closing.



Easy Assembly and Removal: The new LEGRABOX front fixing bracket enables fast and safe assembly and removal. All you need to do is place the front in its holding position and it will easily clip into place.

Thanks to the holding positions, even very wide fronts can easily be removed by one person alone.



FEATURES



Versatile Designs: Alongside LEGRABOX pure with matt, metallic surfaces, the LEGRABOX free design version allows height C high fronted pull-outs to be customised to individual designs.

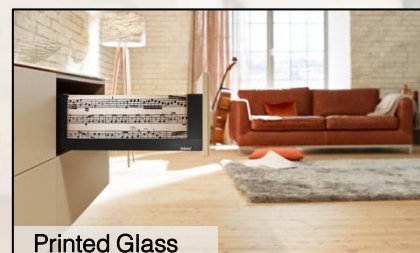
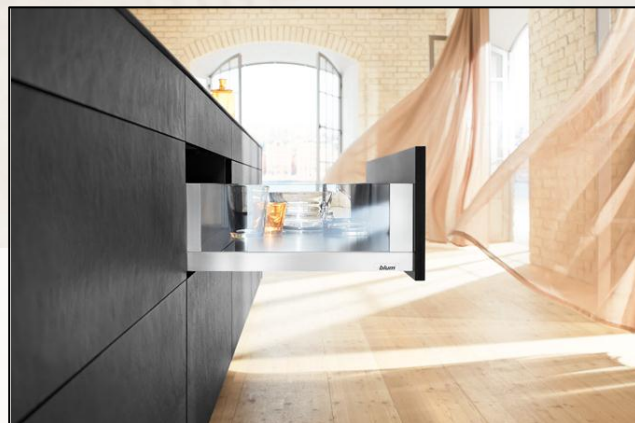

Printed Glass

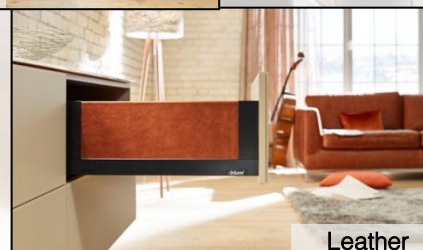

Leather

Individual Accents: The LEGRABOX free design version makes each piece of furniture look unique. The large space effectively highlights the design element that could be made of glass, wood, leather or stone



Wood



Concrete

TECHNOLOGY



BLUMOTION

by Blum

***BLUMOTION:** The integrated, adaptive dampening system always closes softly and effortlessly.*



SERVODRIVE

by Blum

***SERVODRIVE:** With the electrical motion support, handle-less furniture can be opened with a simple press. SERVODRIVE can be combined with BLUMOTION for a silent and effortless closing action.*

***Note:** the fittings for SERVODRIVE remain the same as those used in TANDEMBOX*

RANGE OVERVIEW

LEGRABOX pure



Standard Drawers

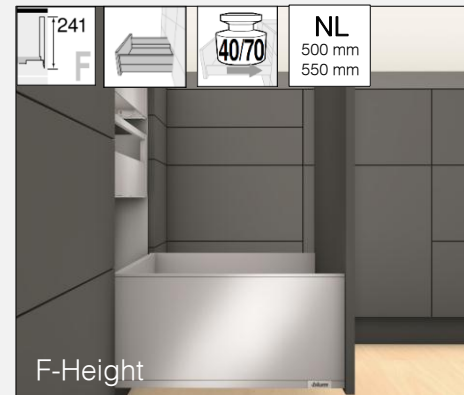

Inner Drawers



Note: The installation of the C-height inner drawer comes with an option of installing either a low design element with the help of spacers or a high design element

RANGE OVERVIEW

LEGRABOX pure



SPACETOWERS (1 M-Height Inner Drawer; 40 Kgs. and 4 C-Height Inner Drawers; 70 Kgs.)



Larder Units (5 C-Height Inner Drawers; 40 Kgs.)

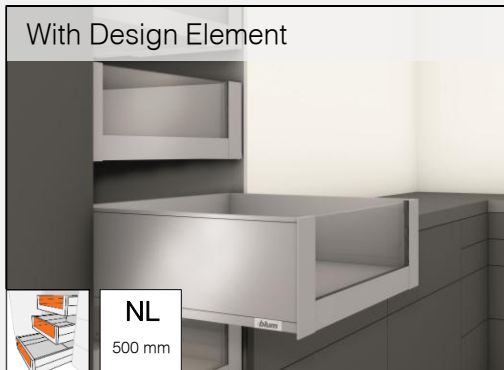
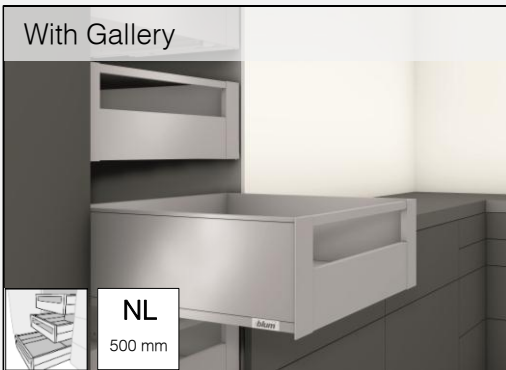

Narrow Cabinets (Top: M-Height Standard Drawer; Bottom: C-Height Standard Drawer)



Sink Unit (Exterior: C-Height Drawer Side; Interior: M-Height Drawer Side)



RANGE OVERVIEW

LEGRABOX free



LEGRABOX free is available only for the C Drawer Side Height

Standard Drawers



Inner Drawers

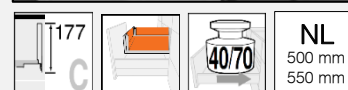
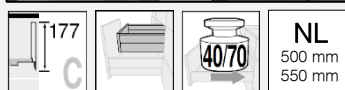

SPACETOWERS (1 M-Height Inner Drawer; 40 Kgs. and 4 C-Height Inner Drawers; 70 Kgs.)

Larder Units (5 C-Height Inner Drawers; 40 Kgs.)

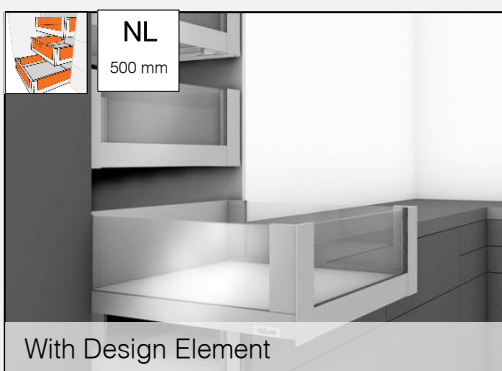

Sink Unit (Exterior: C-Height Drawer Side; Interior: M-Height Drawer Side)

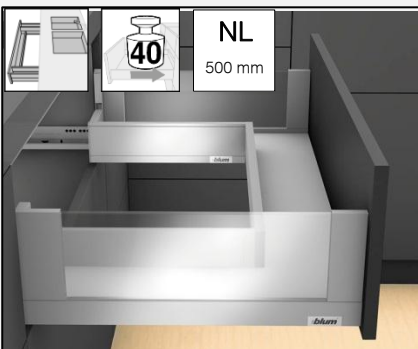









Note: The installation of the C-height inner drawer comes with an option of installing either a low design element with the help of spacers or a high design element

BOM COMPONENTS

FOR STANDARD DRAWERS : FRONT AND BACK FIXING BRACKETS



Heights	M-Height: 90.5 mm	C-Height: 177 mm	F-Height: 241 mm
Symmetrical Front Fixing Bracket (on one side)		 	  
Total (on both sides)	2	4	6
Back Fixing Bracket (on one side)			
Total (on both sides)	2	2	2



BOM COMPONENTS: LEGRABOX pure FOR STANDARD M-HEIGHT DRAWERS

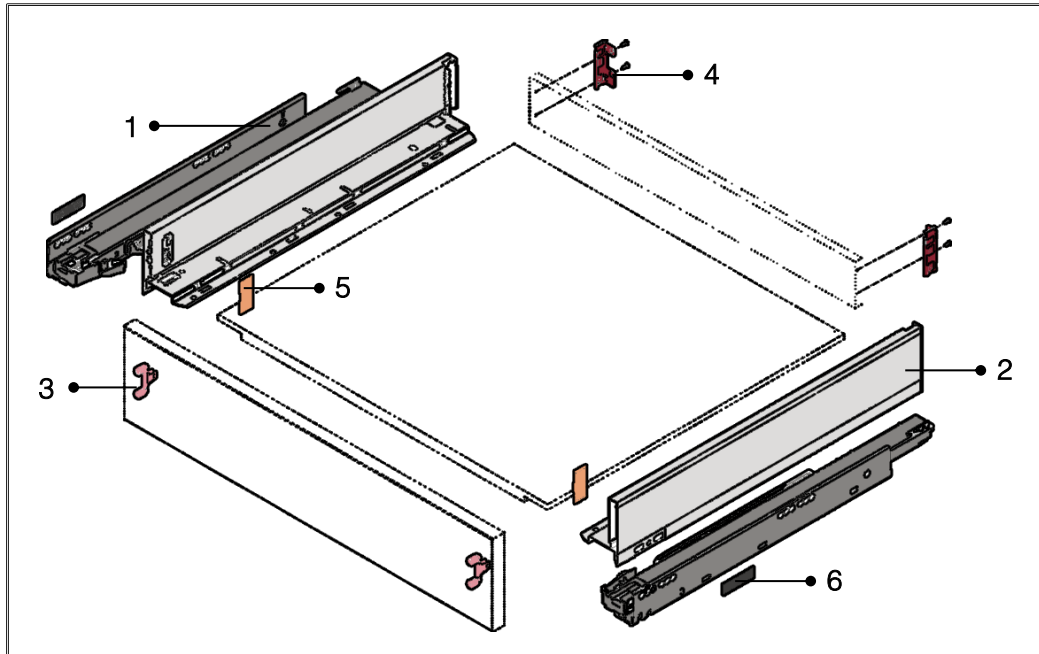

Key	BOM Component
1	Cabinet Profiles (Left and Right)
2	Drawer Sides (Left and Right)
3	EXPANDO Front Fixing Bracket
4	Back Fixing Bracket (Left and Right)
5	Internal Rectangular Symmetrical Cover Cap
6	External Rectangular Symmetrical Printed Cover Cap

Note: BOM Components for a standard C and F-height drawer remain the same as the M-Height (shown above) except for the front fixing and back fixing brackets (refer to Pg. 12 for details)

BOM COMPONENTS : LEGRABOX free FOR STANDARD C-HEIGHT DRAWERS

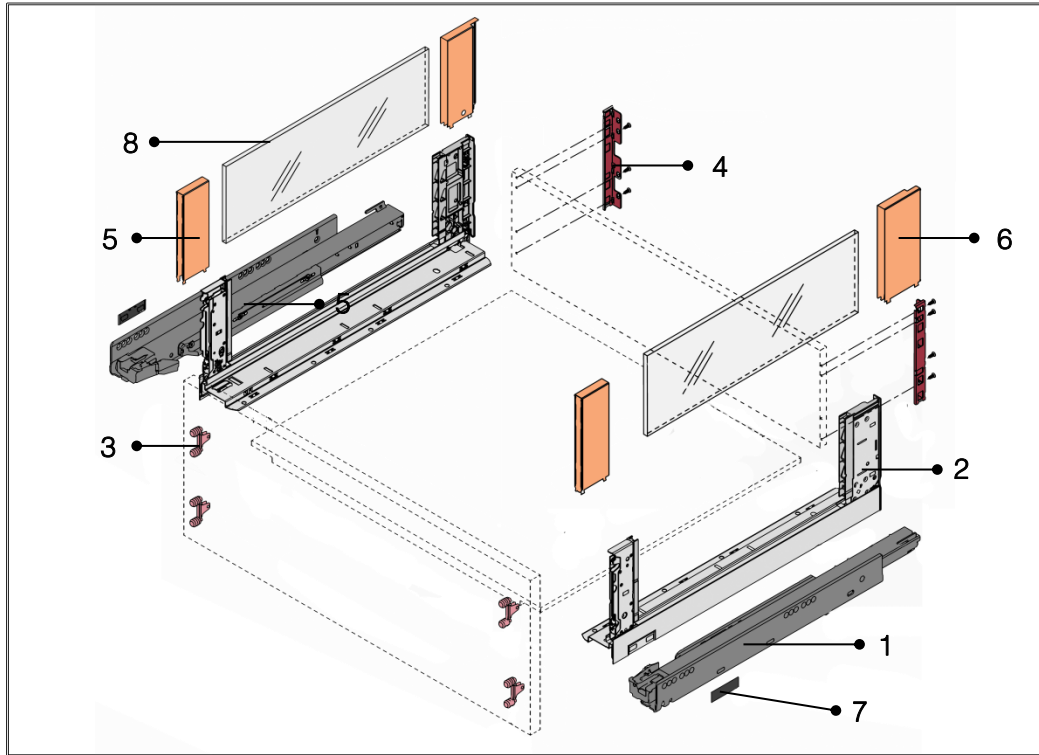

Key	BOM Component
1	Cabinet Profiles (Left and Right)
2	Drawer Sides (Left and Right)
3	EXPANDO Front Fixing Bracket
4	Back Fixing Bracket (Left and Right)
5	Box Cover Front (Left and Right)
6	Box Cover Back (Left and Right)
7	External Rectangular Symmetrical Printed Cover Cap
8	Design Element - Side (To be procured externally)



BOM COMPONENTS: LEGRABOX pure

M-HEIGHT INNER DRAWER: WITHOUT DESIGN ELEMENT

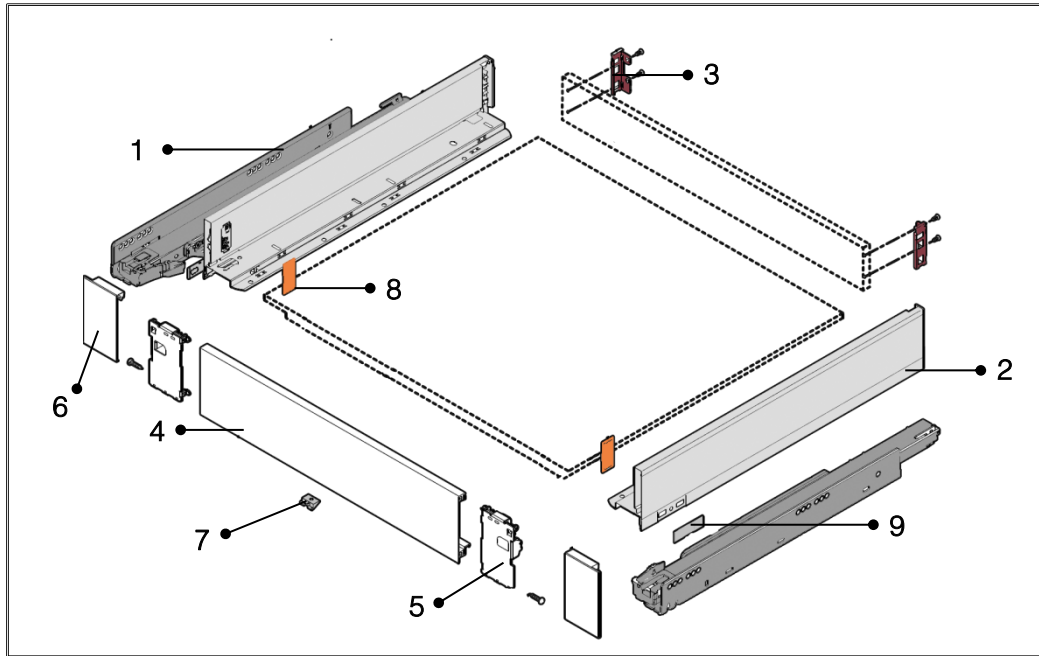

Key	BOM Component
1	Cabinet Profiles (Left and Right)
2	Drawer Side (Left and Right)
3	Back Fixing Bracket (Left and Right)
4	Front Section without Groove (Length: 1080 mm, to be cut to size)
5	Nickel Front Fixing Bracket (Left and Right) with Fixing Screws
6	External Front Fixing Cover Cap (Left and Right)
7	Locking Piece
8	Internal Rectangular Symmetrical Cover Cap
9	External Rectangular Symmetrical Printed Cover Cap

Note: Latch and Latch Housing, used for synchronised opening of the inner and the high-fronted pull-out, need to be ordered separately, if required.





BOM COMPONENTS: LEGRABOX pure

M-HEIGHT INNER DRAWER: WITH DESIGN ELEMENT

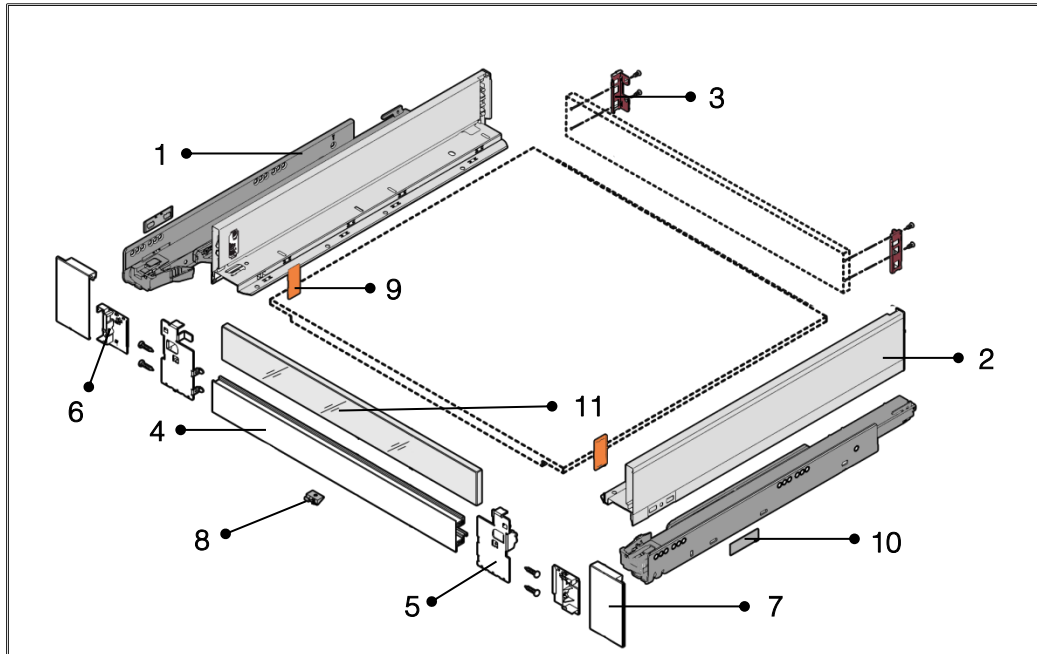

Key	BOM Component
1	Cabinet Profiles (Left and Right)
2	Drawer Side (Left and Right)
3	Back Fixing Bracket (Left and Right)
4	Front Section with Groove (Length: 1043 mm, to be cut to size)
5	Nickel Front Fixing Bracket (Left and Right) with Fixing Screws
6	Internal Front Fixing Cover Cap (Left and Right)
7	External Front Fixing Cover Cap (Left and Right)
8	Locking Piece
9	Internal Rectangular Symmetrical Cover Cap
10	External Rectangular Symmetrical Printed Cover Cap
11	Design Element – Front and Side (To be procured externally)

Note: Latch and Latch Housing, used for synchronised opening of the inner and the high-fronted pull-out, need to be ordered separately, if required.





BOM COMPONENTS: LEGRABOX pure

C-HEIGHT INNER DRAWER: WITH GALLERY

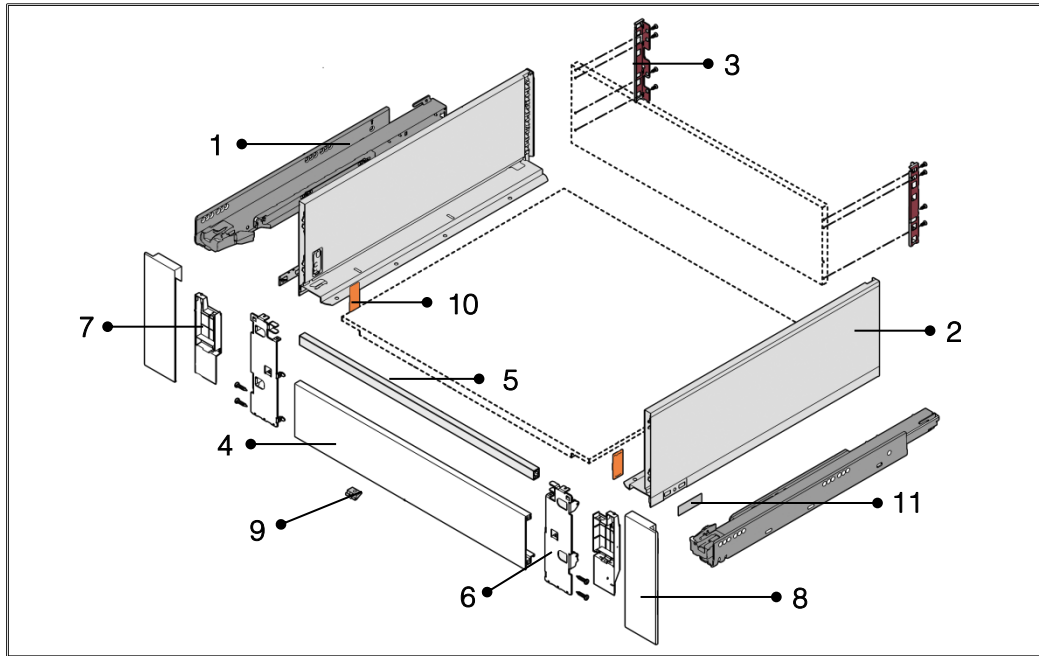

Key	BOM Component
1	Cabinet Profiles (Left and Right)
2	Drawer Side (Left and Right)
3	Back Fixing Bracket (Left and Right)
4	Front Section without Groove (Length : 1043 mm, to be cut to size)
5	Gallery (Length: 1080 mm, to be cut to size)
6	Nickel Front Fixing Bracket (Left and Right) with Fixing Screws
7	Internal Front Fixing Cover Cap (Left and Right)
8	External Front Fixing Cover Cap (Left and Right)
9	Locking Piece
10	Internal Rectangular Symmetrical Cover Cap
11	External Rectangular Symmetrical Printed Cover Cap

Note: Latch and Latch Housing, used for synchronised opening of the inner and the high-fronted pull-out, need to be ordered separately, if required.





BOM COMPONENTS: LEGRABOX free

C-HEIGHT INNER DRAWER: WITH GALLERY

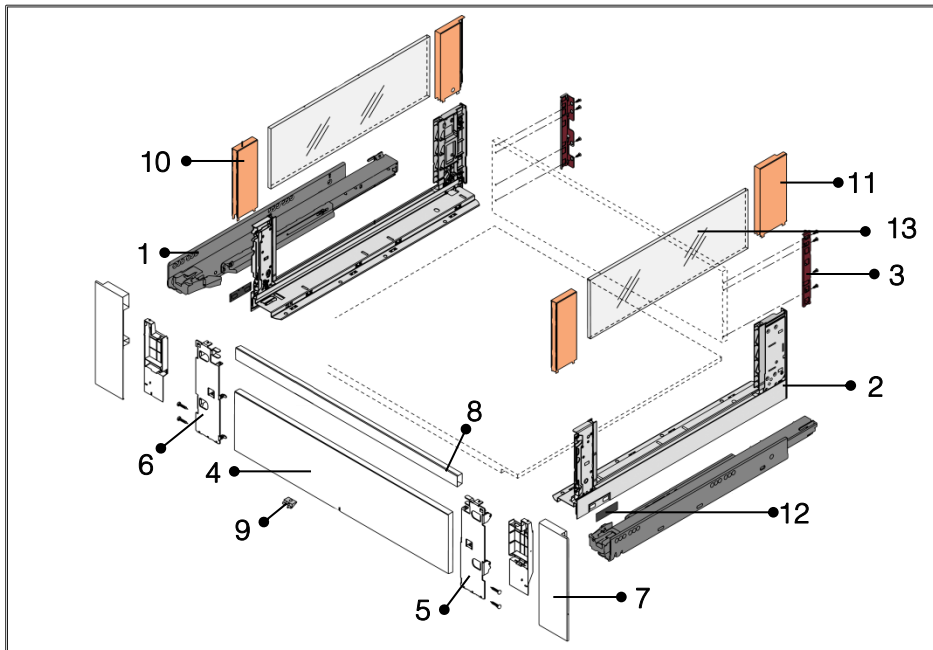

Key	BOM Component
1	Cabinet Profiles (Left and Right)
2	Drawer Side (Left and Right)
3	Back Fixing Bracket (Left and Right)
4	Front Section with Groove (Length :1043 mm, to be cut to size)
5	Nickel Front Fixing Bracket (Left and Right) with Fixing Screws
6	Internal Front Fixing Cover Cap (Left and Right)
7	External Front Fixing Cover Cap (Left and Right)
8	Gallery (Length: 1080 mm, to be cut to size)
9	Locking Piece
10	Box Cover Front (Left and Right)
11	Box Cover Back (Left and Right)
12	External Rectangular Symmetrical Printed Cover Cap
13	Design Element –Side (To be procured externally)

Note: Latch and Latch Housing, used for synchronised opening of the inner and the high-fronted pull-out, need to be ordered separately, if required.





BOM COMPONENTS: LEGRABOX pure

C-HEIGHT INNER DRAWER: WITH LOW / HIGH DESIGN ELEMENT

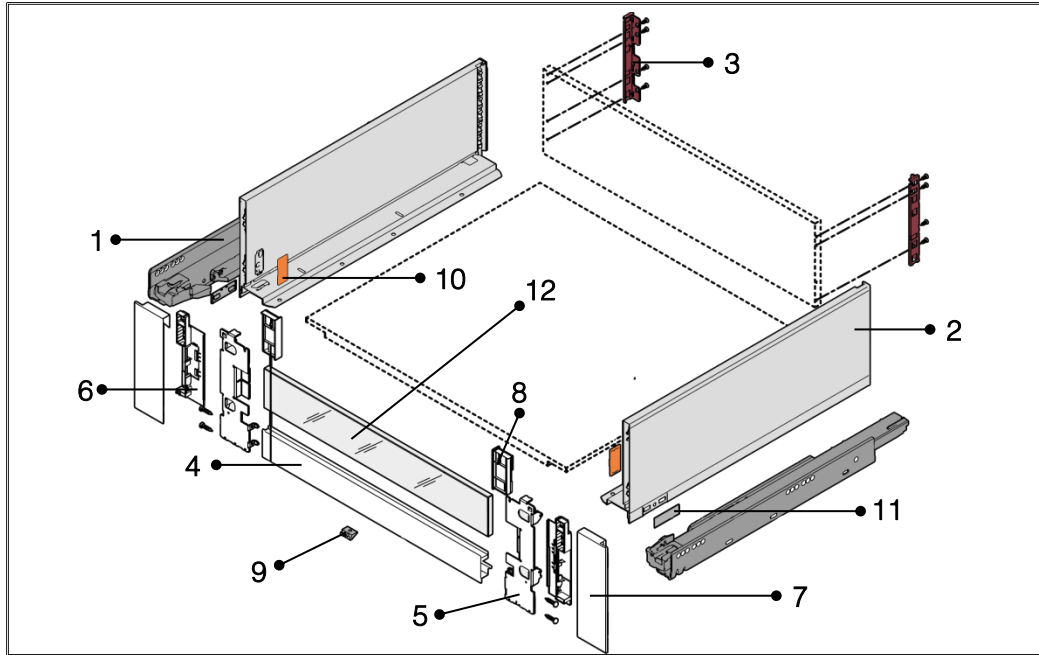

Key	BOM Component
1	Cabinet Profiles (Left and Right)
2	Drawer Side (Left and Right)
3	Back Fixing Bracket (Left and Right)
4	Front Section with Groove (Length :1043 mm, to be cut to size)
5	Nickel Front Fixing Bracket (Left and Right) with Fixing Screws
6	Internal Front Fixing Cover Cap (Left and Right)
7	External Front Fixing Cover Cap (Left and Right)
8	Distance Adjustment Bracket (Left and Right) to be used for low glass design element
9	Locking Piece
10	Internal Rectangular Symmetrical Cover Cap
11	External Rectangular Symmetrical Printed Cover Cap
12	Design Element – Front and Side (To be procured externally)

Note: Latch and Latch Housing, used for synchronised opening of the inner and the high-fronted pull-out, need to be ordered separately, if required.





BOM COMPONENTS: LEGRABOX free

C-HEIGHT INNER DRAWER: WITH LOW / HIGH DESIGN ELEMENT

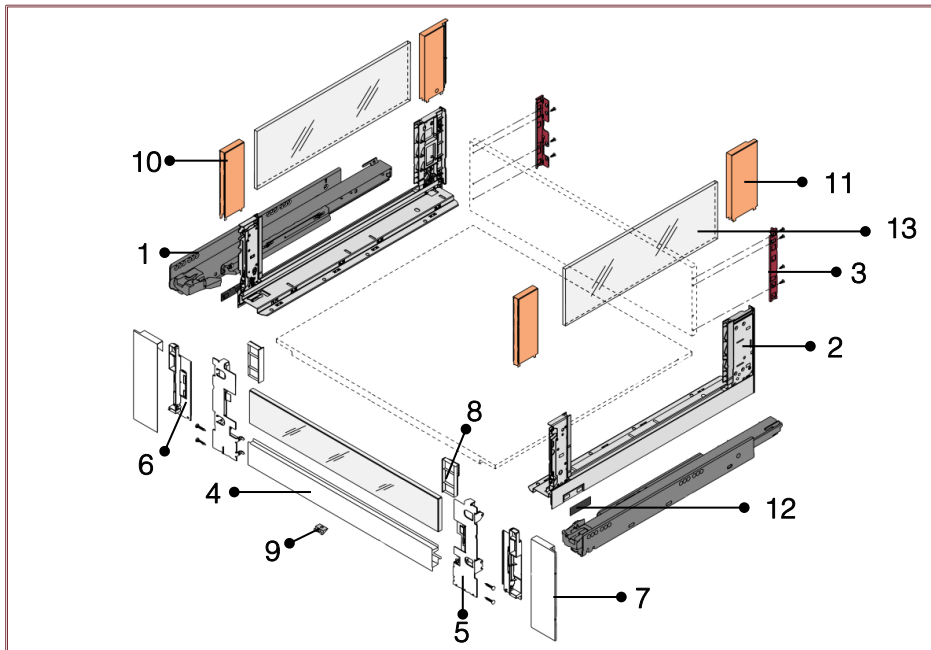

Key	BOM Component
1	Cabinet Profiles (Left and Right)
2	Drawer Side (Left and Right)
3	Back Fixing Bracket (Left and Right)
4	Front Section with Groove (Length :1043 mm, to be cut to size)
5	Nickel Front Fixing Bracket (Left and Right) with Fixing Screws
6	Internal Front Fixing Cover Cap (Left and Right)
7	External Front Fixing Cover Cap (Left and Right)
8	Distance Adjustment Bracket (Left and Right) to be used for low glass design element
9	Locking Piece
10	Box Cover Front (Left and Right)
11	Box Cover Back (Left and Right)
12	External Rectangular Symmetrical Printed Cover Cap
13	Design Element – Front and Side (To be procured externally)

Note: Latch and Latch Housing, used for synchronised opening of the inner and the high-fronted pull-out, need to be ordered separately, if required.





BOM COMPONENTS: LEGRABOX pure

SINK CABINET

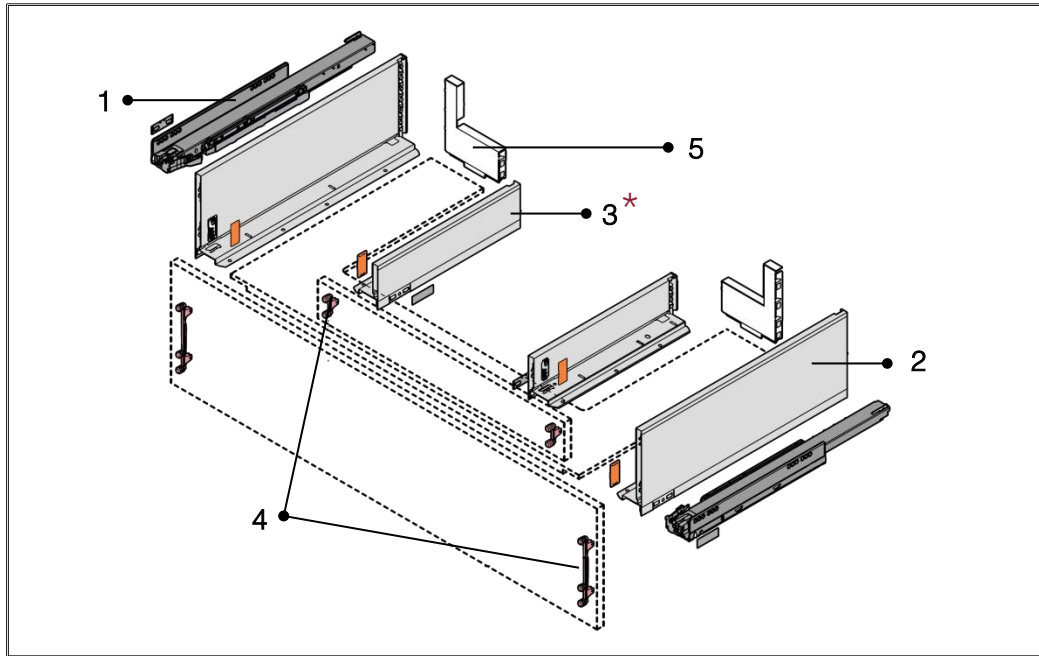

Key	BOM Component
1	Cabinet Profiles (Left and Right)
2	Standard exterior drawer side height C including Internal and External Cover Caps
3	Standard interior drawer side height M* including Internal and External Cover Caps
4	L-shape steel back (for cabinet widths of 900 mm and more)
5	Front fixing height C/height M

* 150 mm shorter than the exterior drawer side



BOM COMPONENTS: LEGRABOX free SINK CABINET

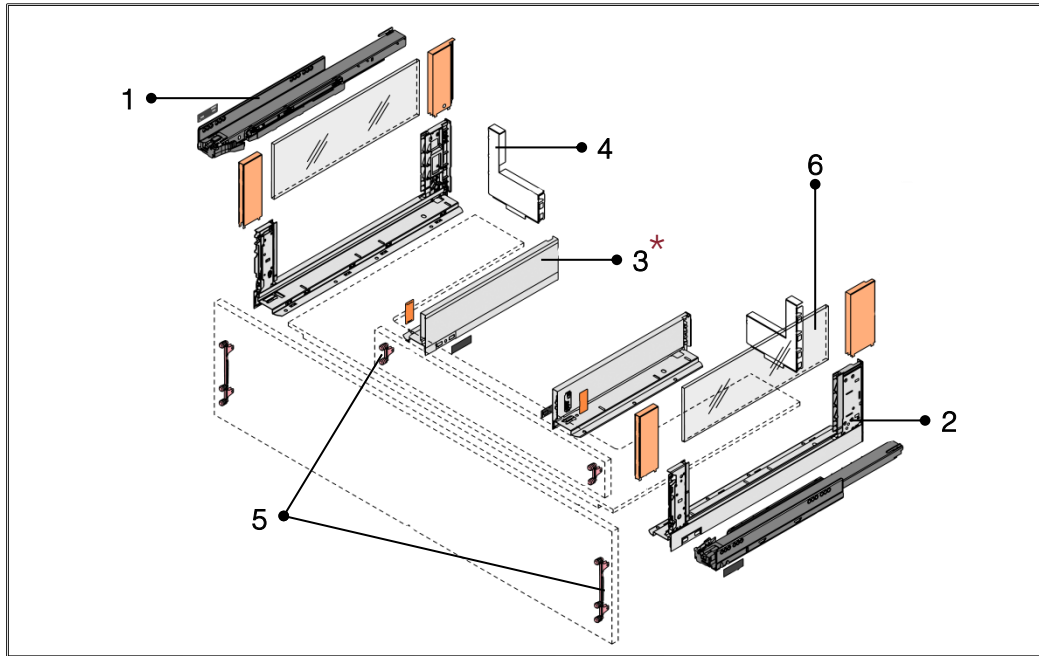



Key	BOM Component
1	Cabinet Profiles (Left and Right)
2	Standard exterior drawer side height C including Box Cover (Front and Back) and External Cover Caps
3	Standard interior drawer side height M* including Internal and External Cover Caps
4	L-shape steel back (for cabinet widths of 900 mm and more)
5	Front fixing height C/height M
6	Design Element –Side (To be procured externally)

* 150 mm shorter than the exterior drawer side

RANGE COMPARISON

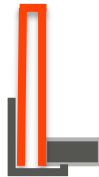

LEGRABOX V/S TANDEMBOX



Range Name:	LEGRABOX	TANDEMBOX																												
Runner Technology:	Works on the MOVENTO Runner principle	Works on the TANDEM Runner principle																												
Weight Carrying Capacity:	40 and 70 Kg.	30 and 65 Kg.																												
Design:	Straight and thin (world's thinnest) double wall box-side 	Conical and thicker double wall box-side 																												
Programmes (Variety):	<ul style="list-style-type: none">LEGRABOX pureLEGRABOX free	<ul style="list-style-type: none">TANDEMBOX plusTANDEMBOX intivoTANDEMBOX antaro																												
Height Options:	<table><tr><th>Heights</th><th>Pure</th><th>Free</th></tr><tr><td>M (90.7 mm)</td><td>√</td><td>-</td></tr><tr><td>C (177 mm)</td><td>√</td><td>√</td></tr><tr><td>F (241 mm)</td><td>√</td><td>-</td></tr></table>	Heights	Pure	Free	M (90.7 mm)	√	-	C (177 mm)	√	√	F (241 mm)	√	-	<table><tr><th>Heights</th><th>Plus</th><th>Antaro</th><th>Intivo</th></tr><tr><td>M (83 mm)</td><td>√</td><td>√</td><td>√</td></tr><tr><td>B (139.5 mm)</td><td>√</td><td>-</td><td>-</td></tr><tr><td>D (203.5 mm)</td><td>√</td><td>√</td><td>√</td></tr></table>	Heights	Plus	Antaro	Intivo	M (83 mm)	√	√	√	B (139.5 mm)	√	-	-	D (203.5 mm)	√	√	√
Heights	Pure	Free																												
M (90.7 mm)	√	-																												
C (177 mm)	√	√																												
F (241 mm)	√	-																												
Heights	Plus	Antaro	Intivo																											
M (83 mm)	√	√	√																											
B (139.5 mm)	√	-	-																											
D (203.5 mm)	√	√	√																											

RANGE COMPARISON

LEGRABOX V/S TANDEMBOX

Range Name:	LEGRABOX	TANDEMBOX
Disassembly:	The drawer can be easily detached from the runners using the detaching clips on the locking pieces pre-fixed to the runner	The drawer can be detached from the runners by pulling and lifting.
Storage Space:	The space available widthwise for storage would be : LW (internal width) minus 41mm	The space available widthwise for storage would be : LW (internal width) minus 75mm
Storage Stability:	Increased storage stability due to completely straight drawer sides 	Storage items are secured from falling out by the drawer side 
Height Options:	Standard Drawers: M, C and F Inner Drawers: M and C	Standard and Inner Drawers: M, B and D
High Fronted Drawers:	High fronted drawers have greater stability of motion with lower sag values	Lower stability of motion and higher sag values when used with high fronted drawers (as compared to LEGRABOX drawers)
Adjustments:	All 3 adjusting screws are conveniently placed and easily accessible on the inside of the drawer sides (rear and front)	The height and side adjusting screws are placed on the outsides of the drawer sides. Tilt adjustment can be done via galleries (plus, antaro) or a screw placed below cover cap (intivo).
Soft Close:	The soft close is safely enclosed in a separate housing protecting it from dust, wood chippings etc.	The soft close unit (BLUMOTION /BLUMATIC) has no additional housing
Applications:	Standard and Inner Drawers, Tall Units, SPACETOWERS, Narrow and Sink Cabinets	Standard and Inner Drawers, Tall Units, SPACETOWERS, Narrow and Sink Cabinets, SPACE CORNERS
Inner Dividing System:	AMBIA-LINE	ORGA-LINE

IMPORTANT INFORMATION

- For cabinet widths at and greater than **900 mm up to 1400 mm**, the use of **Side Stabiliser** (provides additional support and stabilisation for extra wide-fronted pull-outs) that can be cut to size and a **Base Stabiliser** (reinforces the connection between the base and the front) is recommended.

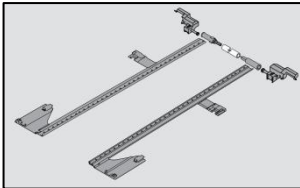

Side Stabiliser

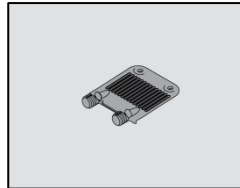

Base Stabiliser

- For fixing the Drawer Sides to the base and the Back Fixing Brackets to the back panel we require **Pan Head Screws** (included in the BOMS) while for fixing the Runners we require **Chipboard Screws** (to be ordered separately).

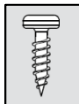

Pan Head Screws



Chip Board Screws

- The **adjustment screws** of LEGRABOX can only be acted upon by a **Torx Screwdriver Size 20** (Needs to be ordered separately).
- Latch and Latch Housing, used for synchronised opening of the inner and the high-fronted pull-out, need to be ordered separately, if required.

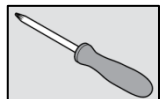

Design Element:

- Design Element for M and C-Height Inner Drawers needs to be **procured externally**
- The installation of the C-height inner drawer comes with an option of installing either a **low design element** with the help of spacers or a **high design element**.
- The **width (X)** for both low and high design element should be:
 - Front : LW (Internal Cabinet Width) – 80 mm
 - Side : NL (Nominal Length) – 112 mm
- The **thickness** of both low and high design element should be **10 mm**
- While the **height (Y)** for:
 - Low design element should be: 70 mm
 - High design element should be: 138 mm

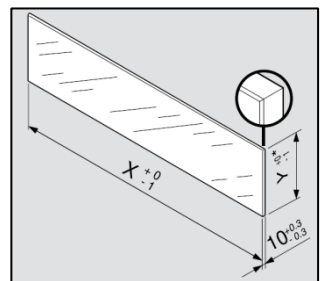



BOM ARTICLE NUMBER TABLE : **LEGRABOX** pure

Type	Height	Weight	Nominal Length	Orion Grey Matt	Silk White Matt	Terra Black Matt	Anti-fingerprint Stainless Steel
Standard Drawers	M	40 Kg.	500 mm	LEG.SD.50MG4	LEG.SD.50MW4	LEG.SD.50MB4	LEG.SD.50MS4
			550 mm	LEG.SD.55MG4	LEG.SD.55MW4	LEG.SD.55MB4	LEG.SD.55MS4
	C	40 Kg.	500 mm	LEG.SD.50CG4	LEG.SD.50CW4	LEG.SD.50CB4	LEG.SD.50CS4
			550 mm	LEG.SD.55CG4	LEG.SD.55CW4	LEG.SD.55CB4	LEG.SD.55CS4
		70 Kg.	500 mm	LEG.SD.50CG7	LEG.SD.50CW7	LEG.SD.50CB7	LEG.SD.50CS7
			550 mm	LEG.SD.55CG7	LEG.SD.55CW7	LEG.SD.55CB7	LEG.SD.55CS7
	F	40 Kg.	500 mm	LEG.SD.50FG4	LEG.SD.50FW4	LEG.SD.50FB4	LEG.SD.50FS4
			550 mm	LEG.SD.55FG4	LEG.SD.55FW4	LEG.SD.55FB4	LEG.SD.55FS4
		70 Kg.	500 mm	LEG.SD.50FG7	LEG.SD.50FW7	LEG.SD.50FB7	LEG.SD.50FS7
			550 mm	LEG.SD.55FG7	LEG.SD.55FW7	LEG.SD.55FB7	LEG.SD.55FS7
Inner Drawers	M without design element	40 Kg.	500 mm	LEG.IG.50MG4	LEG.IG.50MW4	LEG.IG.50MB4	LEG.IG.50MS4
			550 mm	LEG.IG.55MG4	LEG.IG.55MW4	LEG.IG.55MB4	LEG.IG.55MS4
	M with design element	40 Kg.	500 mm	LEG.ID.50MG4	LEG.ID.50MW4	LEG.ID.50MB4	LEG.ID.50MS4
			550 mm	LEG.ID.55MG4	LEG.ID.55MW4	LEG.ID.55MB4	LEG.ID.55MS4
	C with gallery	40 Kg.	500 mm	LEG.IG.50CG4	LEG.IG.50CW4	LEG.IG.50CB4	LEG.IG.50CS4
			550 mm	LEG.IG.55CG4	LEG.IG.55CW4	LEG.IG.55CB4	LEG.IG.55CS4
		70 Kg.	500 mm	LEG.IG.50CG7	LEG.IG.50CW7	LEG.IG.50CB7	LEG.IG.50CS7
			550 mm	LEG.IG.55CG7	LEG.IG.55CW7	LEG.IG.55CB7	LEG.IG.55CS7



BOM ARTICLE NUMBER TABLE : **LEGRABOX** pure

Type	Height	Weight	Nominal Length	Orion Grey Matt	Silk White Matt	Terra Black Matt	Anti-fingerprint Stainless Steel
Inner Drawers	C with design element	40 Kg.	500 mm	LEG.ID.50CG4	LEG.ID.50CW4	LEG.ID.50CB4	LEG.ID.50CS4
			550 mm	LEG.ID.55CG4	LEG.ID.55CW4	LEG.ID.55CB4	LEG.ID.55CS4
		70 Kg.	500 mm	LEG.ID.50CG7	LEG.ID.50CW7	LEG.ID.50CB7	LEG.ID.50CS7
			550 mm	LEG.ID.55CG7	LEG.ID.55CW7	LEG.ID.55CB7	LEG.ID.55CS7
SPACE-TOWERS	M & C with gallery	M-Height (1): 40 Kg. C-Height (4): 70 Kg.	500 mm	LEG.TU.50PGG	LEG.TU.50PWG	LEG.TU.50PBG	LEG.TU.50PSG
	M & C with design element		500 mm	LEG.TU.50PGD	LEG.TU.50PWD	LEG.TU.50PBD	LEG.TU.50PSD
Larder Units	C with gallery	C-Height (5): 40 Kg.	500 mm	LEG.LU.50PGG	LEG.LU.50PWG	LEG.LU.50PBG	LEG.LU.50PSG
	C with design element		500 mm	LEG.LU.50PGD	LEG.LU.50PWD	LEG.LU.50PBD	LEG.LU.50PSD
Narrow Cabinets	Top: M Bottom: C	20 Kg.	500 mm	LEG.NC.50PG2	LEG.NC.50PW2	LEG.NC.50PB2	LEG.NC.50PS2
			550 mm	LEG.NC.55PG2	LEG.NC.55PW2	LEG.NC.55PB2	LEG.NC.55PS2
Sink Cabinets	Interior: M Exterior: C	40 Kg.	500 mm	LEG.SU.50PG4	LEG.SU.50PW4	N/A	LEG.SU.50PS4



BOM ARTICLE NUMBER TABLE : **LEGRABOX free**

Type	Height	Weight	Nominal Length	Orion Grey Matt	Silk White Matt	Terra Black Matt	Anti-fingerprint Stainless Steel
Standard Drawers	C	40 Kg.	500 mm	LEF.SD.50CG4	LEF.SD.50CW4	LEF.SD.50CB4	LEF.SD.50CS4
			550 mm	LEF.SD.55CG4	LEF.SD.55CW4	LEF.SD.55CB4	LEF.SD.55CS4
		70 Kg.	500 mm	LEF.SD.50CG7	LEF.SD.50CW7	LEF.SD.50CB7	LEF.SD.50CS7
			550 mm	LEF.SD.55CG7	LEF.SD.55CW7	LEF.SD.55CB7	LEF.SD.55CS7
Inner Drawers	C with gallery	40 Kg.	500 mm	LEF.IG.50CG4	LEF.IG.50CW4	LEF.IG.50CB4	LEF.IG.50CS4
			550 mm	LEF.IG.55CG4	LEF.IG.55CW4	LEF.IG.55CB4	LEF.IG.55CS4
		70 Kg.	500 mm	LEF.IG.50CG7	LEF.IG.50CW7	LEF.IG.50CB7	LEF.IG.50CS7
			550 mm	LEF.IG.55CG7	LEF.IG.55CW7	LEF.IG.55CB7	LEF.IG.55CS7
	C with design element	40 Kg.	500 mm	LEF.ID.50CG4	LEF.ID.50CW4	LEF.ID.50CB4	LEF.ID.50CS4
			550 mm	LEF.ID.50CG4	LEF.ID.55CW4	LEF.ID.55CB4	LEF.ID.55CS4
		70 Kg.	500 mm	LEF.ID.50CG7	LEF.ID.50CW7	LEF.ID.50CB7	LEF.ID.50CS7
			550 mm	LEF.ID.55CG7	LEF.ID.55CW7	LEF.ID.55CB7	LEF.ID.55CS7
SPACE-TOWERS	C with gallery	M-Height (1): 40 Kg.	500 mm	LEG.TU.50FGG	LEG.TU.50FWG	LEG.TU.50FGG	LEG.TU.50FSG
	C with design element	C-Height (4): 70 Kg	500 mm	LEG.TU.50FGD	LEG.TU.50FWD	LEG.TU.50FGD	LEG.TU.50FSD



BOM ARTICLE NUMBER TABLE : **LEGRABOX free**

Type	Height	Weight	Nominal Length	Orion Grey Matt	Silk White Matt	Terra Black Matt	Anti-fingerprint Stainless Steel
Larder Units	C with gallery	C-Height (5): 40 Kg.	500 mm	LEG.LU.50FGG	LEG.LU.50FWG	LEG.LU.50FBG	LEG.LU.50FSG
	C with design element		500 mm	LEG.LU.50FGD	LEG.LU.50FWD	LEG.LU.50FBD	LEG.LU.50FSD
Sink Units	Interior: M Exterior: C	40 Kg.	500 mm	LEG.SU.50FG4	LEG.SU.50FW4	N/A	LEG.SU.50FS4

ORDERING INFORMATION : BOM ARTICLES

LEGRABOX pure



BOM Article No.	Finish	M.R.P. (INR)
Standard Drawers		
Standard Drawer : Height – M, Weight – 40Kg., Nominal Length – 500 mm		
LEG.SD.50MG4	Orion Grey Matt	6,160/-
LEG.SD.50MW4	Silk White Matt	6,160/-
LEG.SD.50MB4	Terra Black Matt	6,160/-
LEG.SD.50MS4	Anti-Fingerprint Stainless Steel	9,002/-
Standard Drawer : Height – M, Weight – 40Kg., Nominal Length – 550 mm		
LEG.SD.55MG4	Orion Grey Matt	6,668/-
LEG.SD.55MW4	Silk White Matt	6,668/-
LEG.SD.55MB4	Terra Black Matt	6,668/-
LEG.SD.55MS4	Anti-Fingerprint Stainless Steel	9,573/-
Standard Drawer : Height – C, Weight – 40Kg., Nominal Length – 500 mm		
LEG.SD.50CG4	Orion Grey Matt	7,948/-
LEG.SD.50CW4	Silk White Matt	7,948/-
LEG.SD.50CB4	Terra Black Matt	7,948/-
LEG.SD.50CS4	Anti-Fingerprint Stainless Steel	13,076/-
Standard Drawer : Height – C, Weight – 40Kg., Nominal Length – 550 mm		
LEG.SD.55CG4	Orion Grey Matt	8,454/-
LEG.SD.55CW4	Silk White Matt	8,454/-
LEG.SD.55CB4	Terra Black Matt	8,454/-
LEG.SD.55CS4	Anti-Fingerprint Stainless Steel	13,789/-
Standard Drawer : Height – C, Weight – 70Kg., Nominal Length – 500 mm		
LEG.SD.50CG7	Orion Grey Matt	8,739/-
LEG.SD.50CW7	Silk White Matt	8,739/-
LEG.SD.50CB7	Terra Black Matt	8,739/-
LEG.SD.50CS7	Anti-Fingerprint Stainless Steel	13,866/-



ORDERING INFORMATION : BOM ARTICLES

LEGRABOX pure

BOM Article No.	Finish	M.R.P. (INR)
Standard Drawers		
Standard Drawer : Height – C, Weight – 70Kg., Nominal Length – 550 mm		
LEG.SD.55CG7	Orion Grey Matt	9,244/-
LEG.SD.55CW7	Silk White Matt	9,244/-
LEG.SD.55CB7	Terra Black Matt	9,244/-
LEG.SD.55CS7	Anti-Fingerprint Stainless Steel	14,579/-
Standard Drawer : Height – F, Weight – 40Kg., Nominal Length – 500 mm		
LEG.SD.50FG4	Orion Grey Matt	11,312/-
LEG.SD.50FW4	Silk White Matt	11,312/-
LEG.SD.50FB4	Terra Black Matt	11,312/-
LEG.SD.50FS4	Anti-Fingerprint Stainless Steel	17,276/-
Standard Drawer : Height – F, Weight – 40Kg., Nominal Length – 550 mm		
LEG.SD.55FG4	Orion Grey Matt	11,845/-
LEG.SD.55FW4	Silk White Matt	11,845/-
LEG.SD.55FB4	Terra Black Matt	11,845/-
LEG.SD.55FS4	Anti-Fingerprint Stainless Steel	18,011/-
Standard Drawer : Height – F, Weight – 70Kg., Nominal Length – 500 mm		
LEG.SD.50FG7	Orion Grey Matt	12,102/-
LEG.SD.50FW7	Silk White Matt	12,102/-
LEG.SD.50FB7	Terra Black Matt	12,102/-
LEG.SD.50FS7	Anti-Fingerprint Stainless Steel	18,529/-
Standard Drawer : Height – F, Weight – 70Kg., Nominal Length – 550 mm		
LEG.SD.55FG7	Orion Grey Matt	12,636/-
LEG.SD.55FW7	Silk White Matt	12,636/-
LEG.SD.55FB7	Terra Black Matt	12,636/-
LEG.SD.55FS7	Anti-Fingerprint Stainless Steel	19,282/-



ORDERING INFORMATION : BOM ARTICLES

LEGRABOX pure

BOM Article No.	Finish	M.R.P. (INR)
Inner Drawers		
Inner Drawer : Height – M, Without Design Element, Weight – 40Kg., Nominal Length – 500 mm		
LEG.IG.50MG4	Orion Grey Matt	9,725/-
LEG.IG.50MW4	Silk White Matt	9,725/-
LEG.IG.50MB4	Terra Black Matt	9,241/-
LEG.IG.50MS4	Anti-Fingerprint Stainless Steel	16,776/-
Inner Drawer : Height – M, Without Design Element, Weight – 40Kg., Nominal Length – 550 mm		
LEG.IG.55MG4	Orion Grey Matt	10,233/-
LEG.IG.55MW4	Silk White Matt	10,233/-
LEG.IG.55MB4	Terra Black Matt	9,750/-
LEG.IG.55MS4	Anti-Fingerprint Stainless Steel	17,346/-
Inner Drawer : Height – M, With Design Element, Weight – 40Kg., Nominal Length – 500 mm		
LEG.ID.50MG4	Orion Grey Matt	9,791/-
LEG.ID.50MW4	Silk White Matt	9,791/-
LEG.ID.50MB4	Terra Black Matt	9,329/-
LEG.ID.50MS4	Anti-Fingerprint Stainless Steel	16,039/-
Inner Drawer : Height – M, With Design Element, Weight – 40Kg., Nominal Length – 550 mm		
LEG.ID.55MG4	Orion Grey Matt	10,300/-
LEG.ID.55MW4	Silk White Matt	10,300/-
LEG.ID.55MB4	Terra Black Matt	9,838/-
LEG.ID.55MS4	Anti-Fingerprint Stainless Steel	16,610/-
Inner Drawer : Height – C, With Gallery, Weight – 40Kg., Nominal Length – 500 mm		
LEG.IG.50CG4	Orion Grey Matt	13,173/-
LEG.IG.50CW4	Silk White Matt	13,173/-
LEG.IG.50CB4	Terra Black Matt	12,484/-
LEG.IG.50CS4	Anti-Fingerprint Stainless Steel	25,856/-



ORDERING INFORMATION : BOM ARTICLES

LEGRABOX pure

BOM Article No.	Finish	M.R.P. (INR)
Inner Drawer : Height – C, With Gallery, Weight – 40Kg., Nominal Length – 550 mm		
LEG.IG.55CG4	Orion Grey Matt	13,679/-
LEG.IG.55CW4	Silk White Matt	13,679/-
LEG.IG.55CB4	Terra Black Matt	12,989/-
LEG.IG.55CS4	Anti-Fingerprint Stainless Steel	26,569/-
Inner Drawer : Height – C, With Gallery, Weight – 70Kg., Nominal Length – 500 mm		
LEG.IG.50CG7	Orion Grey Matt	13,964/-
LEG.IG.50CW7	Silk White Matt	13,964/-
LEG.IG.50CB7	Terra Black Matt	13,274/-
LEG.IG.50CS7	Anti-Fingerprint Stainless Steel	26,646/-
Inner Drawer : Height – C, With Gallery, Weight – 70Kg., Nominal Length – 550 mm		
LEG.IG.55CG7	Orion Grey Matt	14,469/-
LEG.IG.55CW7	Silk White Matt	14,469/-
LEG.IG.55CB7	Terra Black Matt	13,780/-
LEG.IG.55CS7	Anti-Fingerprint Stainless Steel	27,359/-
Inner Drawer : Height – C, With Design Element, Weight – 40Kg., Nominal Length – 500 mm		
LEG.ID.50CG4	Orion Grey Matt	12,287/-
LEG.ID.50CW4	Silk White Matt	12,287/-
LEG.ID.50CB4	Terra Black Matt	11,825/-
LEG.ID.50CS4	Anti-Fingerprint Stainless Steel	21,458/-
Inner Drawer : Height – C, With Design Element, Weight – 40Kg., Nominal Length – 550 mm		
LEG.ID.55CG4	Orion Grey Matt	12,792/-
LEG.ID.55CW4	Silk White Matt	12,792/-
LEG.ID.55CB4	Terra Black Matt	12,330/-
LEG.ID.55CS4	Anti-Fingerprint Stainless Steel	22,171/-



ORDERING INFORMATION : BOM ARTICLES

LEGRABOX pure

BOM Article No.	Finish	M.R.P. (INR)
Inner Drawer : Height – C, With Design Element, Weight – 70Kg., Nominal Length – 500 mm		
LEG.ID.50CG7	Orion Grey Matt	13,077/-
LEG.ID.50CW7	Silk White Matt	13,077/-
LEG.ID.50CB7	Terra Black Matt	12,615/-
LEG.ID.50CS7	Anti-Fingerprint Stainless Steel	22,249/-
Inner Drawer : Height – C, With Design Element, Weight – 70Kg., Nominal Length – 550 mm		
LEG.ID.55CG7	Orion Grey Matt	13,583/-
LEG.ID.55CW7	Silk White Matt	13,583/-
LEG.ID.55CB7	Terra Black Matt	13,121/-
LEG.ID.55CS7	Anti-Fingerprint Stainless Steel	22,962/-
SPACETOWERS		
SPACETOWER: Height - M (1) & C (4), Weight - 40 Kg. (M) & 70 Kg. (C), With Gallery, Nominal Length – 500 mm		
LEG.TU.50PGG	Orion Grey Matt	65,581/-
LEG.TU.50PWG	Silk White Matt	65,581/-
LEG.TU.50PBG	Terra Black Matt	62,338/-
LEG.TU.50PSG	Anti-Fingerprint Stainless Steel	123,360/-
SPACETOWER: Height - M (1) & C (4), Weight - 40 Kg. (M) & 70 Kg. each (C), With Design Element, Nominal Length – 500 mm		
LEG.TU.50PGD	Orion Grey Matt	62,034/-
LEG.TU.50PWD	Silk White Matt	62,034/-
LEG.TU.50PBD	Terra Black Matt	59,624/-
LEG.TU.50PSD	Anti-Fingerprint Stainless Steel	105,770/-

ORDERING INFORMATION : BOM ARTICLES

LEGRABOX pure



BOM Article No.	Finish	M.R.P. (INR)
Larder Units		
Larder Units: Height - C (5), Weight: 40 Kg. each, With Gallery, Nominal Length – 500 mm		
LEG.LU.50PGG	Orion Grey Matt	65,867/-
LEG.LU.50PWG	Silk White Matt	65,867/-
LEG.LU.50PBG	Terra Black Matt	54359/-
LEG.LU.50PSG	Anti-Fingerprint Stainless Steel	133,230/-
Larder Units: Height - C (5), Weight: 40 Kg. each, With Design Element, Nominal Length – 500 mm		
LEG.LU.50PGD	Orion Grey Matt	61,434/-
LEG.LU.50PWD	Silk White Matt	61,434/-
LEG.LU.50PBD	Terra Black Matt	51,065/-
LEG.LU.50PSD	Anti-Fingerprint Stainless Steel	129,278/-
Narrow Cabinets		
Narrow Cabinets: Height – M (Top) & C (Bottom), Weight: 20 Kg., Nominal Length – 500 mm		
LEG.NC.50PG2	Orion Grey Matt	10,639/-
LEG.NC.50PW2	Silk White Matt	10,639/-
LEG.NC.50PB2	Terra Black Matt	10,639/-
LEG.NC.50PS2	Anti-Fingerprint Stainless Steel	18,609/-
Narrow Cabinets: Height – M (Top) & C (Bottom), Weight: 20 Kg., Nominal Length – 550 mm		
LEG.NC.55PG2	Orion Grey Matt	11,420/-
LEG.NC.55PW2	Silk White Matt	11,420/-
LEG.NC.55PB2	Terra Black Matt	11,420/-
LEG.NC.55PS2	Anti-Fingerprint Stainless Steel	19,660/-
Sink Cabinets		
Sink Cabinets: Height – M (Interior) & C (Exterior), Weight: 40 Kg., Nominal Length – 500 mm		
LEG.SU.50PG4	Orion Grey Matt	13,364/-
LEG.SU.50PW4	Silk White Matt	13,364/-
LEG.SU.50PS4	Anti-Fingerprint Stainless Steel	20,466/-



ORDERING INFORMATION : BOM ARTICLES

LEGRABOX free

BOM Article No.	Finish	M.R.P. (INR)
Standard Drawers		
Standard Drawer : Height – C, Weight – 40Kg., Nominal Length – 500 mm		
LEF.SD.50CG4	Orion Grey Matt	7,982/-
LEF.SD.50CW4	Silk White Matt	7,982/-
LEF.SD.50CB4	Terra Black Matt	7,982/-
LEF.SD.50CS4	Anti-Fingerprint Stainless Steel	12,744/-
Standard Drawer : Height – C, Weight – 40Kg., Nominal Length – 550 mm		
LEF.SD.55CG4	Orion Grey Matt	8,492/-
LEF.SD.55CW4	Silk White Matt	8,492/-
LEF.SD.55CB4	Terra Black Matt	10,076/-
LEF.SD.55CS4	Anti-Fingerprint Stainless Steel	15,705/-
Standard Drawer : Height – C, Weight – 70Kg., Nominal Length – 500 mm		
LEF.SD.50CG7	Orion Grey Matt	8,774/-
LEF.SD.50CW7	Silk White Matt	8,774/-
LEF.SD.50CB7	Terra Black Matt	8,774/-
LEF.SD.50CS7	Anti-Fingerprint Stainless Steel	13,536/-
Standard Drawer : Height – C, Weight – 70Kg., Nominal Length – 550 mm		
LEF.SD.55CG7	Orion Grey Matt	9,282/-
LEF.SD.55CW7	Silk White Matt	9,282/-
LEF.SD.55CB7	Terra Black Matt	10,866/-
LEF.SD.55CS7	Anti-Fingerprint Stainless Steel	16,495/-
Inner Drawers		
Inner Drawer : Height – C, With Gallery, Weight – 40Kg., Nominal Length – 500 mm		
LEF.IG.50CG4	Orion Grey Matt	13,207/-
LEF.IG.50CW4	Silk White Matt	13,207/-
LEF.IG.50CB4	Terra Black Matt	13,207/-
LEF.IG.50CS4	Anti-Fingerprint Stainless Steel	25,525/-



ORDERING INFORMATION : BOM ARTICLES

LEGRABOX free

BOM Article No.	Finish	M.R.P. (INR)
Inner Drawer : Height – C, With Gallery, Weight – 40Kg., Nominal Length – 550 mm		
LEF.IG.55CG4	Orion Grey Matt	13,717/-
LEF.IG.55CW4	Silk White Matt	13,717/-
LEF.IG.55CB4	Terra Black Matt	15,301/-
LEF.IG.55CS4	Anti-Fingerprint Stainless Steel	28,486/-
Inner Drawer : Height – C, With Gallery, Weight – 70Kg., Nominal Length – 500 mm		
LEF.IG.50CG7	Orion Grey Matt	13,999/-
LEF.IG.50CW7	Silk White Matt	13,999/-
LEF.IG.50CB7	Terra Black Matt	13,999/-
LEF.IG.50CS7	Anti-Fingerprint Stainless Steel	26,317/-
Inner Drawer : Height – C, With Gallery, Weight – 70Kg., Nominal Length – 550 mm		
LEF.IG.55CG7	Orion Grey Matt	14,507/-
LEF.IG.55CW7	Silk White Matt	14,507/-
LEF.IG.55CB7	Terra Black Matt	16,091/-
LEF.IG.55CS7	Anti-Fingerprint Stainless Steel	29,276/-
Inner Drawer : Height – C, With Design Element, Weight – 40Kg., Nominal Length – 500 mm		
LEF.ID.50CG4	Orion Grey Matt	12,320/-
LEF.ID.50CW4	Silk White Matt	12,320/-
LEF.ID.50CB4	Terra Black Matt	12,320/-
LEF.ID.50CS4	Anti-Fingerprint Stainless Steel	21,127/-
Inner Drawer : Height – C, With Design Element, Weight – 40Kg., Nominal Length – 550 mm		
LEF.ID.50CG4	Orion Grey Matt	12,830/-
LEF.ID.55CW4	Silk White Matt	12,830/-
LEF.ID.55CB4	Terra Black Matt	14,414/-
LEF.ID.55CS4	Anti-Fingerprint Stainless Steel	24,088/-



ORDERING INFORMATION : BOM ARTICLES

LEGRABOX free

BOM Article No.	Finish	M.R.P. (INR)
Inner Drawer : Height – C, With Design Element, Weight – 70Kg., Nominal Length – 500 mm		
LEF.ID.50CG7	Orion Grey Matt	13,112/-
LEF.ID.50CW7	Silk White Matt	13,112/-
LEF.ID.50CB7	Terra Black Matt	13,112/-
LEF.ID.50CS7	Anti-Fingerprint Stainless Steel	21,919/-
Inner Drawer : Height – C, With Design Element, Weight – 70Kg., Nominal Length – 550 mm		
LEF.ID.55CG7	Orion Grey Matt	13,620/-
LEF.ID.55CW7	Silk White Matt	13,620/-
LEF.ID.55CB7	Terra Black Matt	15,204/-
LEF.ID.55CS7	Anti-Fingerprint Stainless Steel	24,878/-
SPACETOWERS		
SPACETOWER: Height - M (1) & C (4), Weight - 40 Kg. (M) & 70 Kg. (C), With Gallery, Nominal Length – 500 mm		
LEG.TU.50FGG	Orion Grey Matt	65,890/-
LEG.TU.50FWG	Silk White Matt	65,890/-
LEG.TU.50FBG	Terra Black Matt	65,890/-
LEG.TU.50FSG	Anti-Fingerprint Stainless Steel	122,214/-
SPACETOWER: Height - M (1) & C (4), Weight - 40 Kg. (M) & 70 Kg. each (C), With Design Element, Nominal Length – 500 mm		
LEG.TU.50FGD	Orion Grey Matt	62,242/-
LEG.TU.50FWD	Silk White Matt	62,242/-
LEG.TU.50FBD	Terra Black Matt	62,242/-
LEG.TU.50FSD	Anti-Fingerprint Stainless Steel	103,901/-

ORDERING INFORMATION : BOM ARTICLES

LEGRABOX free



BOM Article No.	Finish	M.R.P. (INR)
Larder Units		
Larder Units: Height - C (5), Weight: 40 Kg. each, With Gallery, Nominal Length – 500 mm		
LEG.LU.50FGG	Orion Grey Matt	66,035/-
LEG.LU.50FWG	Silk White Matt	66,035/-
LEG.LU.50FBG	Terra Black Matt	66,035/-
LEG.LU.50FSG	Anti-Fingerprint Stainless Steel	127,625/-
Larder Units: Height - C (5), Weight: 40 Kg. each, With Design Element, Nominal Length – 500 mm		
LEG.LU.50FGD	Orion Grey Matt	61,600/-
LEG.LU.50FWD	Silk White Matt	61,600/-
LEG.LU.50FBD	Terra Black Matt	61,600/-
LEG.LU.50FSD	Anti-Fingerprint Stainless Steel	105,635/-
Sink Cabinets		
Sink Cabinets: Height – M (Interior) & C (Exterior), Weight: 40 Kg., Nominal Length – 500 mm		
LEG.SU.50FG4	Orion Grey Matt	13,462/-
LEG.SU.50FW4	Silk White Matt	13,462/-
LEG.SU.50FS4	Anti-Fingerprint Stainless Steel	20,198/-
Accessories		
B52.09.105	Orion Grey Matt Latch and Latch Housing	955/-
B97.17.615	Silk White Matt Latch and Latch Housing	955/-
B72.28.931	Terra Black Matt Latch and Latch Housing	752/-
B81.42.713	Side Stabilisation Set (Upto NL= 650mm)	3,016/-
B64.48.980	Base Stabiliser	196/-
B95.08.739	Pan Head Screws, Zinc Plated	11/-
B56.12.403	Chip Board Screws, Nickel Plated	5/-
B62.38.822	Screw Driver for Torx Screws	694/-



In case of any query / issue, **SMS 'HAFELE' to 56070**

Our customer care executive will get in touch with you and address your query / issue.



Call us on our dedicated toll-free number: **1800 266 6667**

Customer- friendly, deviation-free call connection to our Customer Care team



Email us on: **customer care@hafeleindia.com**