



This technical information pertaining to the "RAUVISIO brilliant" is valid from April 2021 onwards.

With the publication of this document, the previous versions are no longer valid.

Our current technical documents are available for download at [www.rehau.de/rauvisio-brilliant](http://www.rehau.de/rauvisio-brilliant).

This document is protected by copyright. The rights conferred therein are reserved, in particular those relating to the translation, reprinting, extraction of pictures, electronic transmissions, reproduction by photo-mechanical or similar means and storage on data processing equipment.

All dimensions and weights are approximate. Subject to errors and modifications.

# 01 Information and safety instructions

## Validity

This technical information is valid worldwide.

## Current relevance of the technical information

To ensure your safety and proper use of our products, please regularly check whether a more recent version of the technical information is available.

You can obtain the current version of the document from your specialist retailer, your REHAU sales office or you can download it at [www.rehau.de/rauvisio-brilliant](http://www.rehau.de/rauvisio-brilliant).

## Navigation

At the beginning of this technical information, you will find a detailed table of contents with the hierarchical headings and corresponding page numbers.

## Pictograms and logos



Safety notice



Legal notice



Important information which must be observed



Your benefits



Information available online

## Intended use

RAUVISIO products may only be configured, installed and operated as described in this technical information. Any other use is deemed to be outside the intended scope of application.

## Suitability of the material

Our valid technical information is to be observed for the processing/installation and use of RAUVISIO brilliant. Our technical information is based on empirical values and knowledge acquired up to the time of printing. The dissemination of this information does not comprise any assurance of the properties of the products described. No explicit or implicit guarantee may be derived from it.

The information does not release the user/purchaser from their obligation to assess the suitability of this material and the correct processing thereof to attain the required results in terms of objective and application.

## Disclosure of information

It is essential to ensure that your customers, also including end customers, are aware of the necessity to observe the current technical information as well as instructions for the care and use of RAUVISIO brilliant.

The care and usage instructions must be made available to the end customer either by you or by your customers.

Note to our distribution partners and customers that press RAUVISIO acrylic laminates and resell the laminated boards: Please also inform your customers of the need to follow the current technical information and make this available to them.

Note to processors of pressed acrylic laminate boards: Please ensure that at least the installation guidelines (chapter "9 Installation guidelines") and the care and usage instructions (chapter "10 Care and usage instructions for the end user") are handed over to your customers and to fabrication and installation companies.

### **Safety instructions and installation instructions**

Observe the information on packaging, accessory parts and installation instructions. Keep the installation instructions so that they are always available. If you do not understand the safety instructions or installation recommendations, or if there is any uncertainty with regard to their content, please contact your local REHAU sales office.

### **Relevant regulations and safety equipment**

All applicable safety and environmental regulations as well as the regulations of the trade supervisory centre and professional association must be strictly observed. These always take priority over the instructions and recommendations given in the technical information.

Always use safety equipment such as

- Gloves
- Protective goggles
- Ear protection
- Dust mask

### **Adhesives and additional tools**

Observe the safety regulations for the adhesives used and ensure that they are strictly observed. Always store additional tools such as alcohol-based cleaning products and other easily flammable materials in safe and well-ventilated places.

### **Ventilation/extraction, production dust**

Ensure good ventilation and extraction around the processing machines. If production dust is inhaled, provide fresh air and in the event of symptoms seek medical advice.

### **Protective measures and disposal**

RAUVISIO brilliant is a coextruded material made from acrylic and styrene copolymer that is not harmful to the environment. The dust that forms is not toxic. The dust concentration is to be minimised through suitable protective measures such as extraction and use of a dust mask. Dust from RAUVISIO brilliant presents no specific risk of explosion.

### **Disposal code in accordance with the Waste Catalogue Regulation:**

- 170203/Construction and demolition waste consisting of wood, glass, plastic
- 120105/Waste from mechanical shaping processes and from the physical and mechanical surface treatment of metals and plastics (plastic shavings and lathe shavings)

### **Fire behaviour**

Due to its composition of the main constituents acrylic and styrene copolymer, RAUVISIO brilliant demonstrates favourable fire behaviour and is categorised to DIN 4102-B2 as normal flame resistance. In the event of a fire, no toxic substances such as heavy metals or halogens are released. The same fire-fighting techniques can be used as for construction materials containing wood.

### **Fire-fighting**

Suitable extinguishing agents for fire-fighting are

- Water spray
- Foam
- CO<sub>2</sub>
- Extinguishing powder

A solid-stream water jet is unsuitable for safety reasons.

When fire-fighting, wear suitable protective clothing and if necessary standalone breathing apparatus.

## 02 Product description

### 02.01 Product description

As an acrylic laminate, RAUVISIO brilliant represents the latest trends in furniture design and interior design. The seamless joining of boards and edges results in a flawless, high-gloss or matt component. Thanks to its brilliant depth effect, RAUVISIO brilliant replaces high-quality paint elements when designing surfaces.



Fig. 02-1 RAUVISIO brilliant for high-gloss surfaces

RAUVISIO brilliant has the following advantages:

	RAUVISIO brilliant	RAUVISIO brilliant SR
High gloss	✓	✓
Matt		✓
Hygienic	✓	✓
Water-tight	✓	✓
Can be thermoformed	✓	
Non-porous	✓	✓
Can be processed using conventional woodworking tools	✓	✓
High tension force	✓	✓
Repair of signs of wear possible	✓	
High chemical resistance		✓
High scratch resistance		✓
Monitoring of production centres, TÜV certification	✓	✓
<div>  <div> <p>Qualität Gebrauchs- tauglichkeit Regelmäßige Produktions- überwachung</p> <p>www.tuv.com ID: 000045032</p> </div> <div> <p>For RAUVISIO brilliant complete</p> <p>For RAUVISIO brilliant SR complete</p> </div> </div>		

Tab. 02-1 Advantages of RAUVISIO brilliant

### 02.02 Individual components

All RAUVISIO brilliant components can be ordered separately:

#### RAUVISIO brilliant (high-gloss laminate)

RAUVISIO brilliant is a multi-layer coextruded polymer laminate produced from a styrene copolymer base layer and an acrylate top layer.

Due to the 0.7–0.8 mm thick material combination, RAUVISIO brilliant achieves a high tension force that has a positive effect on the surface smoothness and, in combination with a wooden substrate board, creates a mirror gloss surface.

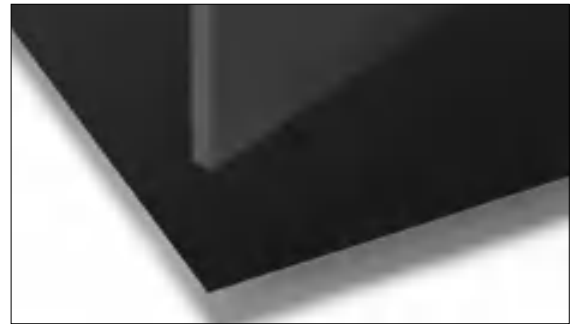

Fig. 02-2 RAUVISIO brilliant for high-gloss surfaces

#### RAUVISIO brilliant SR (high-gloss laminate)

RAUVISIO brilliant SR (high-gloss laminate) is used in places where a high level of chemical and scratch resistance is required. This is achieved by means of a special hard coating.

#### RAUVISIO brilliant SR (matt laminate)

RAUVISIO brilliant SR (matt laminate) is a hard-coated matt variant which behaves like the high-gloss SR surface in terms of its properties. The only difference is the gloss level of the hard coating.



Fig. 02-3 Matt laminate RAUVISIO brilliant SR in the colour moro

### Balancing sheet (embossed)

Our specially developed balancing sheet is a perfect colour match for the acrylic laminate. The material thickness of the balancing sheet of 0.7–0.8 mm ensures minimal warpage of the laminated board.



Fig. 02-4 RAUVISIO brilliant balancing sheet in the colour moro

### Edgeband collection

Whether high-gloss or matt uni-edge, V-groove or 3D look – REHAU offers up to seven different edge design lines for RAUVISIO brilliant (SR) that leave nothing to be desired. In total there are more than 60 edge types available from stock, all perfectly colour-matched to the surface.

As usual with REHAU, all edges are available as RAUKANTEX pure, RAUKANTEX plus or RAUKANTEX pro.



Fig. 02-5 RAUVISIO brilliant edge collection in the colour moro

### 02.03 RAUVISIO brilliant composite pressed board

RAUVISIO brilliant is also available as a large pressed board (1,300 x 2,800 mm), consisting of acrylic laminate, MDF board and colour-matched balancing sheet.

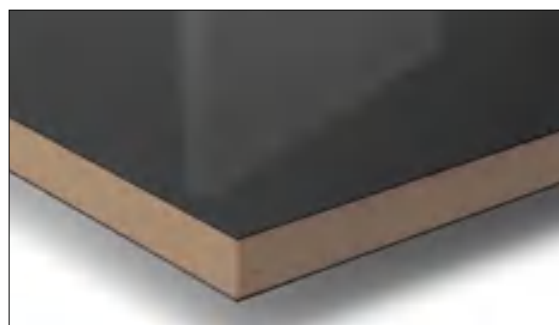

Fig. 02-6 RAUVISIO brilliant balancing sheet in the colour moro

### 02.04 Finished component RAUVISIO brilliant complete

Use the REHAU surface configurator to select RAUVISIO brilliant components and the matching edgebands and we'll deliver individually fabricated zero-joint fronts, or even one-offs.



Fig. 02-7 RAUVISIO brilliant complete finished component in the colour moro

## 03 Transport, packaging and storage

### 03.01 Transport and loading information



The external packaging must be immediately checked for signs of damage upon receipt of the goods:

- If damage has occurred, open the packaging in the presence of the freight carrier and record the damage to the goods.
- This must be confirmed by the driver of the haulage company with their name, haulage company, date and signature.
- The damage must be reported to the freight carrier within 24 hours.

**In the event of a failure to comply with this, the freight carrier's insurance company will not accept liability!**

#### Transport

Under no circumstances should the boards be exposed to temperatures higher than 60 °C during transport to avoid thermal overloading of the adhesive/laminate system.

In the case of increased thermal loading there may be interaction between the adhesive and acrylic laminate that may result in orange peel/waviness and will therefore impair the mirror gloss finish.

#### Delivery

Boards are shipped loaded on square timber battens or pallets to ensure they are kept flat.

- Ideally, packaging units should be unloaded with a forklift or similar appliance.
- If the appropriate lifting equipment is not available, the boards/laminate can be unloaded by hand. If manually unloading, precautions must be taken to ensure the boards/laminate are kept clean and are not subjected to undue mechanical loads (twisting, folding, bending, etc.).
- When unloading by hand, wear suitable protective equipment, e.g. gloves, as sharp edges can cause cuts.
- The use of transport aids such as suction lifters, lift handles and board transporters is recommended for handling; see also chapter "5.1 Unpacking".
- Bending is not permitted during lifting and movement of the RAUVISIO brilliant boards.

### 03.02 Packaging



#### **Protect the boards with foam non-woven material.**

With RAUVISIO brilliant the edges and surfaces must be protected. Particularly when moving, picking and further processing the boards, avoid or remove any dirt that may get between the individual boards. Otherwise the stack pressure/dead weight of the boards will inevitably cause indentations in the laminate surfaces.

- Protect the surfaces with foam wrap. This will avoid marks being caused on the surface when stacking components.

### 03.03 Internal transport and storage

#### Inter-company transport

While being moved RAUVISIO brilliant boards must be fully supported along their complete length, and kept as flat and level as possible.

The ideal method is to transport them in the packing variant in which they were delivered (no repacking recommended).

#### Storage

RAUVISIO brilliant is supplied on pallets or square timber battens covered with appropriate protective boards. The packaging units with RAUVISIO brilliant are stackable. Due to the stack pressure, however, it is not permitted for more than five packaging units to be stored on top of one another.



#### Protecting packaging units (PU)

The packaging units are to be protected against damage, large fluctuations in temperature and humidity, as well as high UV levels of artificial lighting or direct sunlight.

#### Store boards flat and level.

RAUVISIO brilliant must be kept flat, level and fully supported along its complete length.

It is recommended to store boards on the supplied pallet. Alternatively, boards must be supported by a minimum of four evenly spaced timber battens of equal size (see diagram). This is necessary to prevent bending or warping.

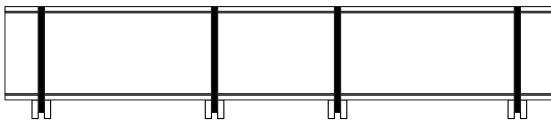

Fig. 03-1 Storage on four battens

In the event of storage in conditions not in line with those described above (pallet or on at least four equal battens), no assurances can be given against warping.

The material must be stored in closed, heated rooms in which the room temperature is between 15 and 25 °C and the relative humidity is between 40 and 60%.

Prior to opening packaging units, boards must be allowed to acclimatise to room temperature for at least 48 hours.

Prior to returning opened or partially used packaging units to storage it must be ensured that the cover plate is replaced on top. This is to prevent contamination and uneven temperature/humidity penetration (due to drafts or heating air), and thus counteract warping effects as well as surface damage.

#### Storage before and after bonding of the laminate

All materials that are bonded together must be acclimatised for a sufficient amount of time and have the same temperature.

After bonding, panels must be stored immediately in enclosed, heated rooms. Ensure that the storage temperature does not exceed 60 °C.